

PROPOSED RESIDENTIAL SUBDIVISION AT LOT 27 ON RP910631 224 CHAMBERS FLAT ROAD, WATERFORD WEST

OPERATIONAL WORKS PACKAGE CONTRACT BE210215-01

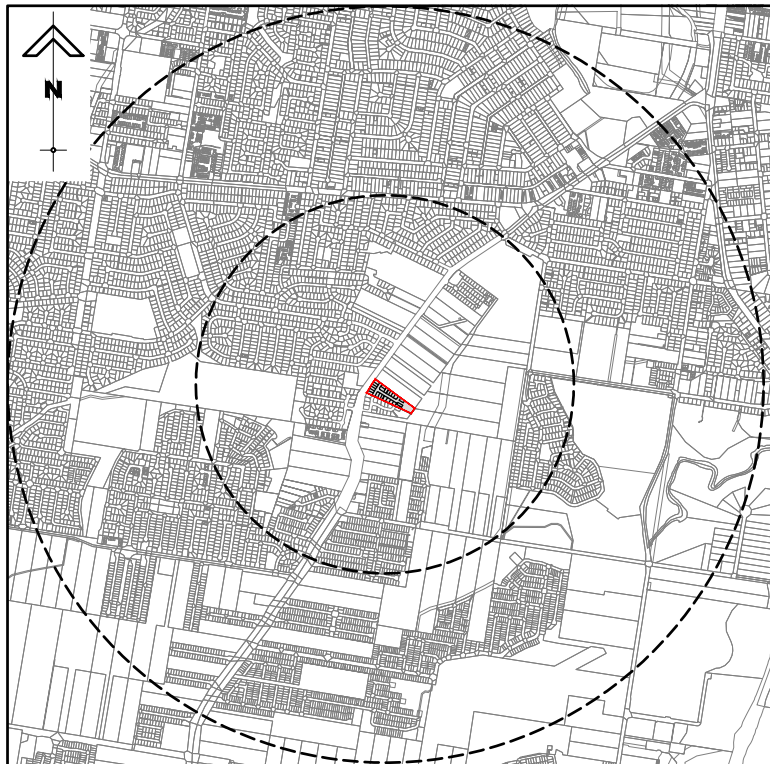

DRAWING INDEX	
DRG. No.	DESCRIPTION
C000	COVER SHEET, LOCALITY PLAN, DRAWING INDEX AND NOTES
C101	TYPICAL CROSS SECTION, NOTES AND DETAILS
C100	OVERAL LAYOUT PLAN
C102	CHAMBERS FLAT ROAD WIDENING CONCEPT PLAN & SECTIONS
C200	PRELIMINARY EARTHWORKS LAYOUT PLAN
C300	PRELIMINARY ROADWORKS AND DRAINAGE PLAN
C301	VEHICLE SWEEP PATH LAYOUT PLAN
C310	PRELIMINARY ROAD LONGITUDINAL SECTIONS
C450	PRELIMINARY BIO-DETENTION BASIN LAYOUT PLAN
C451	BIO-DETENTION BASIN SECTIONS
C800	PRELIMINARY SERVICES LAYOUT PLAN

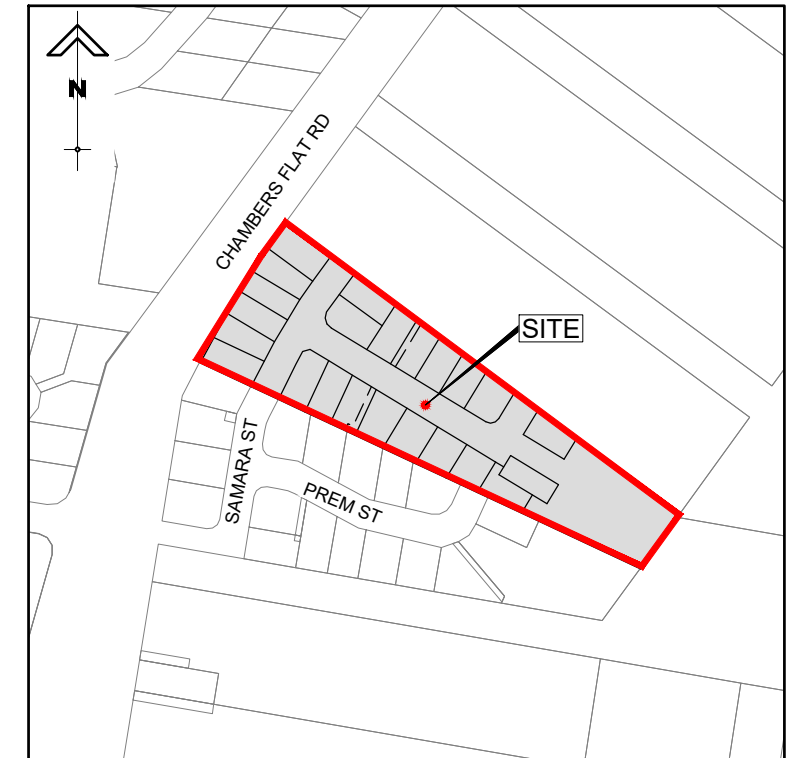

PREPARED FOR
GAFSTEV PTY LTD

PREPARED BY



GOLD COAST | BRISBANE | TOOWOOMBA
IPSWICH | MORETON BAY
PHONE: +61 7 5509 6400
FAX: +61 7 5509 6411
EMAIL: ADMIN@BURCHILLS.COM.AU
COOTE BURCHILLS ENGINEERING PTY LTD
ABN 76 166 942 365

DATE: 10-10-23

PROJECT No.:	DRAWING No.:	VERSION:
BE210215-01	C000	A

RETAINING WALL NOTES:

- RETAINING WALLS, FOOTINGS, DRAINAGE, BACKFILL AND CONNECTION OF AGGREGATE DRAINS TO STORMWATER DRAINAGE SYSTEM TO BE DESIGNED AND CONSTRUCTED BY THE CONTRACTOR AND CERTIFIED BY AN SUITABLY QUALIFIED RPEQ
- THESE DRAWINGS IDENTIFY SURFACE PROFILES, RETAINING WALL LOCATIONS, AND SETOUT INFORMATION ONLY. REFER TO CONTRACTOR SUPPLIED DRAWINGS FOR RPEQ STRUCTURAL DETAILS, WALL MATERIALS AND COMPACTION SPECIFICATIONS AND CONSTRUCTIBILITY INFORMATION.
- RETAINING WALL DESIGN ENGINEER TO PROVIDE RPEQ FORM 15 STRUCTURAL CERTIFICATE INCLUDING GEOTECHNICAL GLOBAL STABILITY CERTIFICATION BY GEOTECHNICAL ENGINEER. WALL DESIGN TO ASSUME SURCHARGE LOADING BEHIND WALL. DESIGN TO BE IN ACCORDANCE WITH AS4678 INCLUDING ALL REQUIRED DESIGN LOAD CASES AND COMBINATIONS.
- RETAINING WALLS TO BE DESIGNED TO CONSIDER ALL LOADS INCLUDING CONSTRUCTION LOADS AND OPERATIONAL LOADS.
- ANY GEOTECHNICAL INFORMATION PROVIDED BY THE PRINCIPAL OR THE SUPERINTENDENT SHALL BE FOR INFORMATION PURPOSES ONLY. THE CONTRACTOR AND THE RETAINING WALL DESIGN ENGINEER SHOULD SATISFY THEMSELVES OF THE DESIGN SOIL PARAMETERS AND UNDERTAKE AN ADDITIONAL GEOTECHNICAL INVESTIGATION DEEMED NECESSARY BY THE DESIGN ENGINEER.
- THE CONTRACTOR SHALL ENSURE THAT ANY CONFLICT BETWEEN THESE PROJECT DRAWINGS AND THE RETAINING WALL DRAWINGS PREPARED BY THE RETAINING WALL DESIGN ENGINEER IS RESOLVED WITH THE SUPERINTENDENT PRIOR TO CONSTRUCTION COMMENCING.
- A COPY OF THE RETAINING WALL DESIGN DRAWINGS, INCLUDING CONNECTION OF AGGREGATE DRAINS TO THE STORMWATER DRAINAGE SYSTEM, DESIGN PARAMETERS AND CERTIFICATION BE PROVIDED TO THE SUPERINTENDENT AT THE PRE-START MEETING PRIOR TO CONSTRUCTION COMMENCING.
- ANY RETAINING WALL AND BATTER EXCEEDING THE HEIGHT OF 1.5m, THE CONTRACTOR SHALL UNDERTAKE A THIRD PARTY RPEQ REVIEW OF THE PROPOSED DESIGN.
- RETAINING WALL ADJACENT TO BIO-BASINS WILL BE DESIGNED AND DETAILED TO BE FOUNDED AT SUCH A DEPTH TO ALLOW FOR FUTURE ACCESS AND MAINTENANCE BY LOGAN CITY COUNCIL. APPROPRIATE PROTECTION MEASURES TO BE DETAILED (ADDITIONAL FOOTING DEPTH, DETECTABLE MARKING TAP/WARNING SIGNAGE TO BE APPLIED AT THE DETAILED DESIGN STAGE).
- RETAINING WALLS TO BE DESIGNED TO ALLOW FOR SERVICE TRENCHING ADJACENT TO BACK OF WALLS/FOOTINGS AS APPROPRIATE.

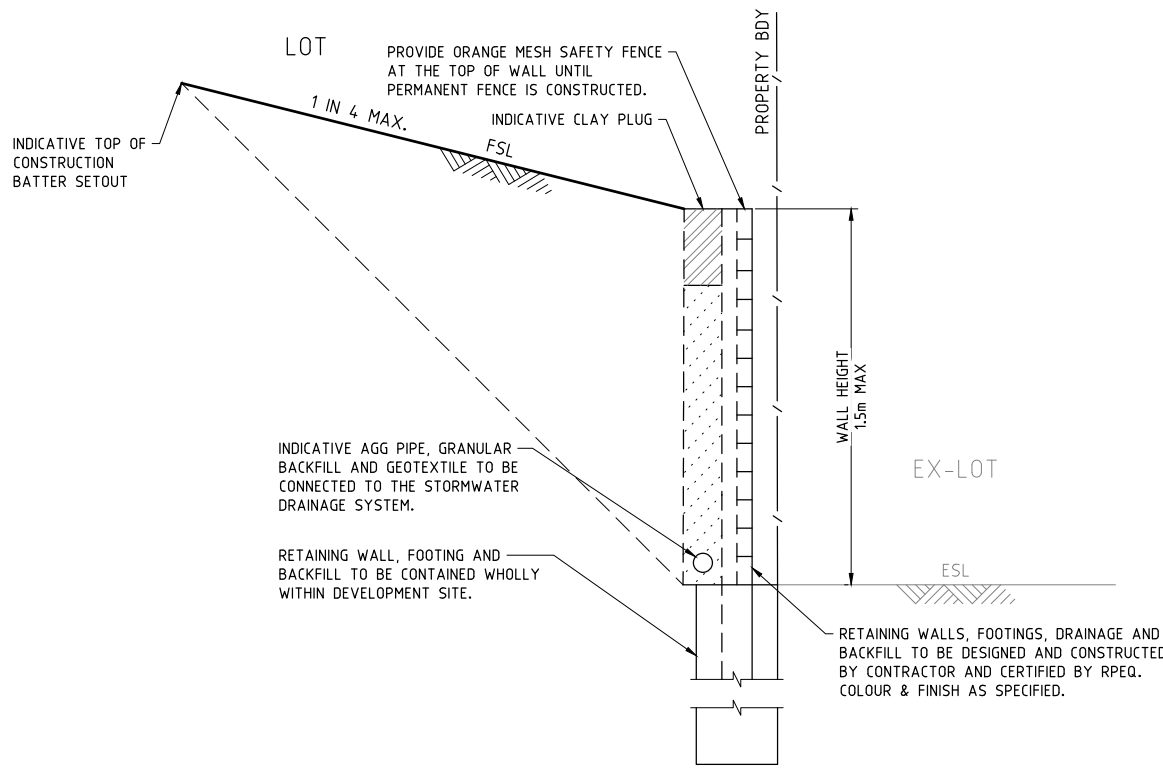

**RETAINING WALL CONFIGURATION
- BETWEEN LOT & EXISTING LOT**

N.T.S.

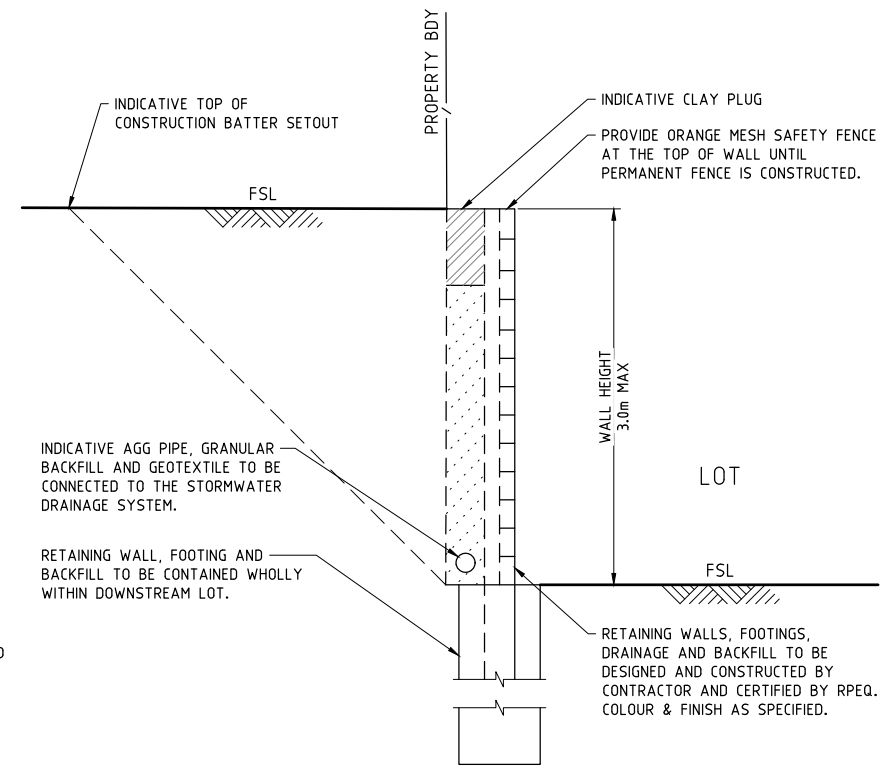

**RETAINING WALL CONFIGURATION
- BETWEEN LOTS**

N.T.S.

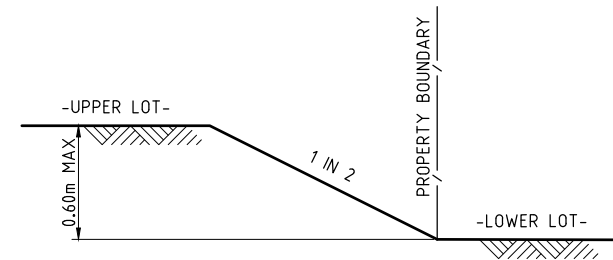

TYPICAL SIDE BOUNDARY BATTER DETAIL

N.T.S.

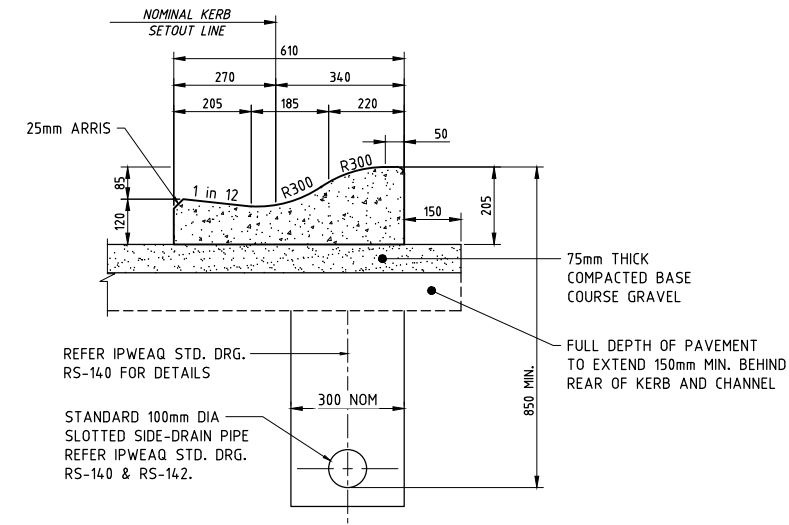

**TYPICAL SECTION 'TYPE M3'
KERB AND CHANNEL (ROLL TOP)**

SCALE 0.1 0.2 0.3 0.4 0.5 (metres)
1 : 10 (FULL SIZE)

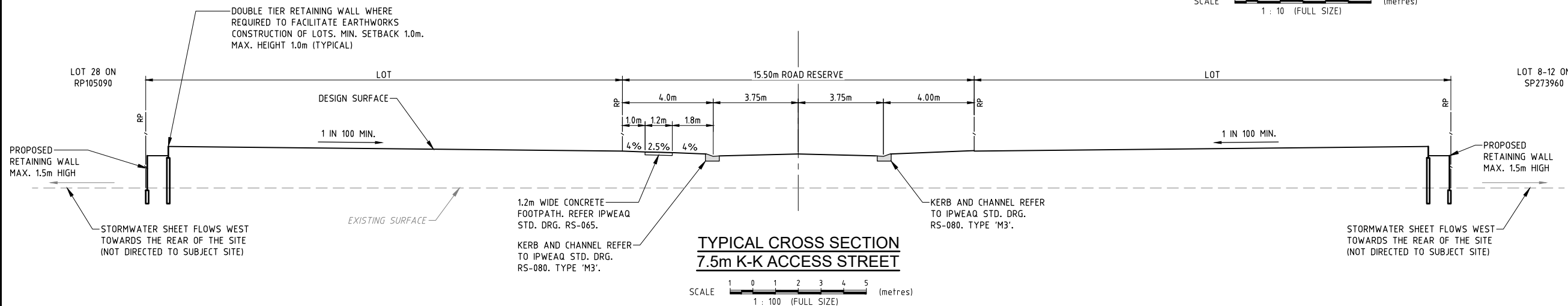

**TYPICAL CROSS SECTION
7.5m K-K ACCESS STREET**

SCALE 1 0 1 2 3 4 5 (metres)
1 : 100 (FULL SIZE)

**PROPOSED
RESIDENTIAL
SUBDIVISION**

LOT 27 ON RP910631, 224
CHAMBERS FLAT ROAD,
WATERFORD WEST

FOR

GAFSTEV PTY LTD

A1 ORIGINAL SIZE BEFORE REDUCTION

VER.	DESCRIPTION	DATE
A	ORIGINAL ISSUE	10-10-23

COPYRIGHT (C)

This drawing is copyright and the property of Burchills Engineering Solutions. If must not be retained, copied or used without the authority of Burchills Engineering Solutions.

DISCLAIMER
This drawing and its contents are electronically generated, are confidential and may only be used for the purpose for which they were intended. Burchills Engineering Solutions will not accept responsibility for any consequences arising from the use of the drawing for other than its intended purpose or where the drawing has been altered, amended or changed either manually or electronically by any third party.

NOTE
This is an uncontrolled document issued for information purposes only, unless the checked sections are signed or completed. Figured dimensions take precedence over scale. Do not scale reduced size drawings. Verify dimensions prior to commencing any on-site or off-site works or fabrication.



GOLD COAST | BRISBANE | TOOWOOMBA
IPSWICH | MORETON BAY
PHONE: +61 7 5509 6400
FAX: +61 7 5509 6411
EMAIL: ADMIN@BURCHILLS.COM.AU
COOTE BURCHILLS ENGINEERING PTY LTD
ABN 76 166 942 365

PROJECT:

**224 CHAMBERS FLAT
ROAD**

DRAWING TITLE:

**TYPICAL CROSS
SECTION, NOTES AND
DETAILS**

DEVEL. APPLIC. No.: RL/57/2021 DATE: 10-10-23

PROJECT LEADER: ROBERTO DI FABIO

DESIGNER: L.D.L.

DRAFTSPERSON: L.D.L.

CHECKED: ROBERTO DI FABIO

APPROVED FOR AND ON BEHALF OF
BURCHILLS ENGINEERING SOLUTIONS ABN 76 166 942 365

RPEQ No.:

SCALE: AS NOTED DATUM: AHD FULL SIZE: A1

PROJECT No.: BE210215-01 DRAWING No.: C101 VERSION: A

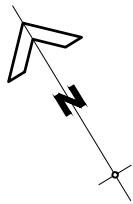

LEGEND

- EXISTING LOT BOUNDARY
- PROPOSED LOT BOUNDARY
- PROPOSED EASEMENT
- DEVELOPMENT SITE BOUNDARY
- DEVELOPMENT SITE

PROPOSED RESIDENTIAL SUBDIVISION

LOT 27 ON RP910631, 224
CHAMBERS FLAT ROAD,
WATERFORD WEST

FOR

GAFSTEV PTY LTD

A1 ORIGINAL SIZE BEFORE REDUCTION

VER.	DESCRIPTION	DATE
A	ORIGINAL ISSUE	10-10-23

COPYRIGHT (C)
This drawing is copyright and the property of Burchills Engineering Solutions. It must not be retained, copied or used without the authority of Burchills Engineering Solutions.

DISCLAIMER
This drawing and its contents are electronically generated, are confidential and may only be used for the purpose for which they were intended. Burchills Engineering Solutions will not accept responsibility for any consequences arising from the use of the drawing for other than its intended purpose or where the drawing has been altered, amended or changed either manually or electronically by any third party.

NOTE
This is an uncontrolled document issued for information purposes only, unless the checked sections are signed or completed. Figured dimensions take precedence over scale. Do not scale reduced size drawings. Verify dimensions prior to commencing any on-site or off-site works or fabrication.

**BURCHILLS
ENGINEERING SOLUTIONS**

GOLD COAST | BRISBANE | TOOWOOMBA
IPSWICH | MORETON BAY
PHONE: +61 7 5509 6400
FAX: +61 7 5509 6411
EMAIL: ADMIN@BURCHILLS.COM.AU
COOTE BURCHILLS ENGINEERING PTY LTD
ABN 76 166 942 365

PROJECT:
224 CHAMBERS FLAT ROAD

DRAWING TITLE:
OVERALL LAYOUT PLAN

DEVEL. APPLIC. No.: RL/57/2021	DATE: 10-10-23	
PROJECT LEADER: ROBERTO DI FABIO		
DESIGNER: L.D.L.		
DRAFTSPERSON: L.D.L.		
CHECKED: ROBERTO DI FABIO		
APPROVED FOR AND ON BEHALF OF BURCHILLS ENGINEERING SOLUTIONS ABN 76 166 942 365		
RPEQ No.:		
SCALE: AS NOTED	DATUM: AHD	FULL SIZE: A1
PROJECT No.: BE210215-01	DRAWING No.: C100	VERSION: A

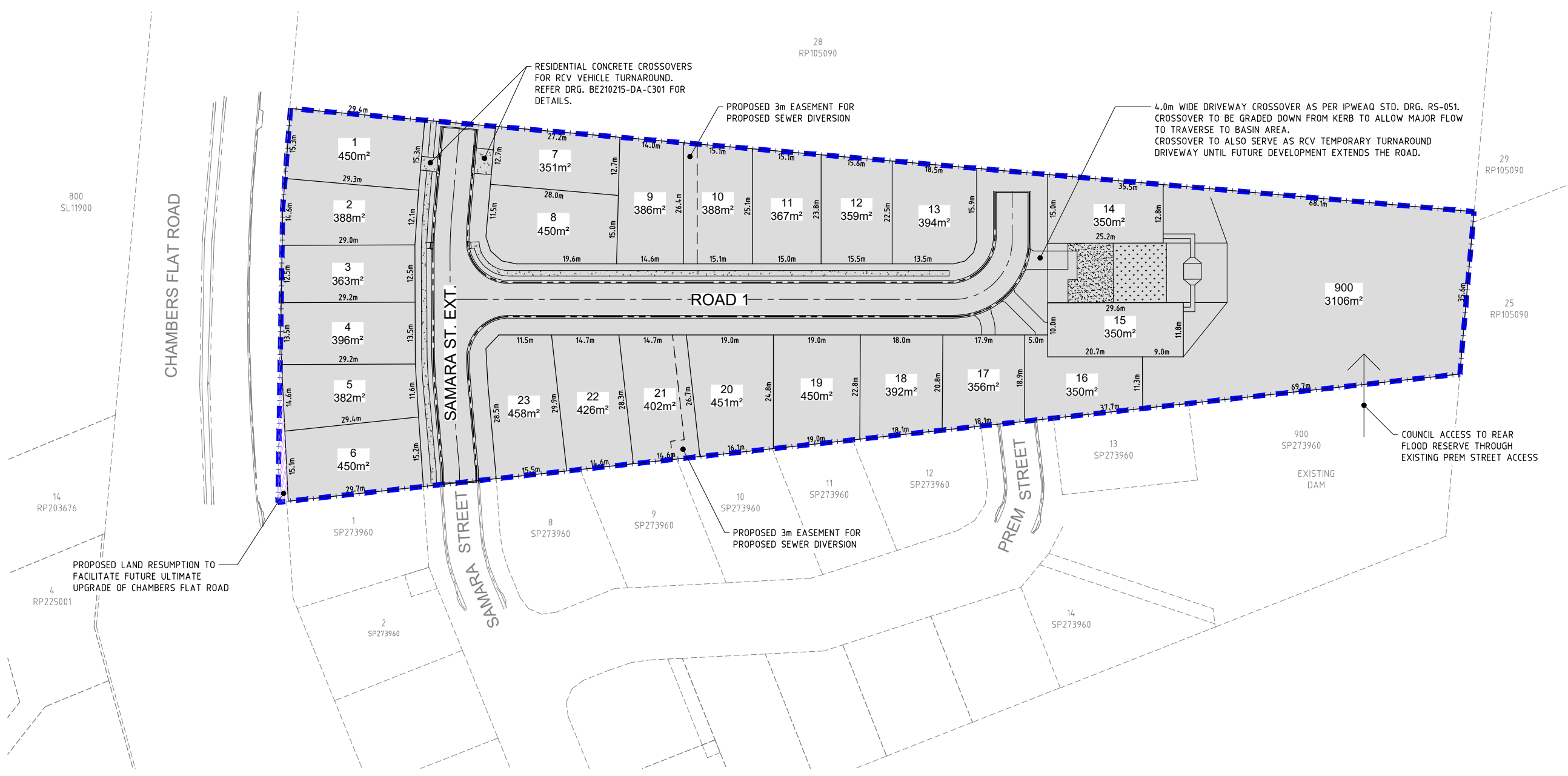

OVERALL LAYOUT PLAN
SCALE 1 : 500 (FULL SIZE) (metres)

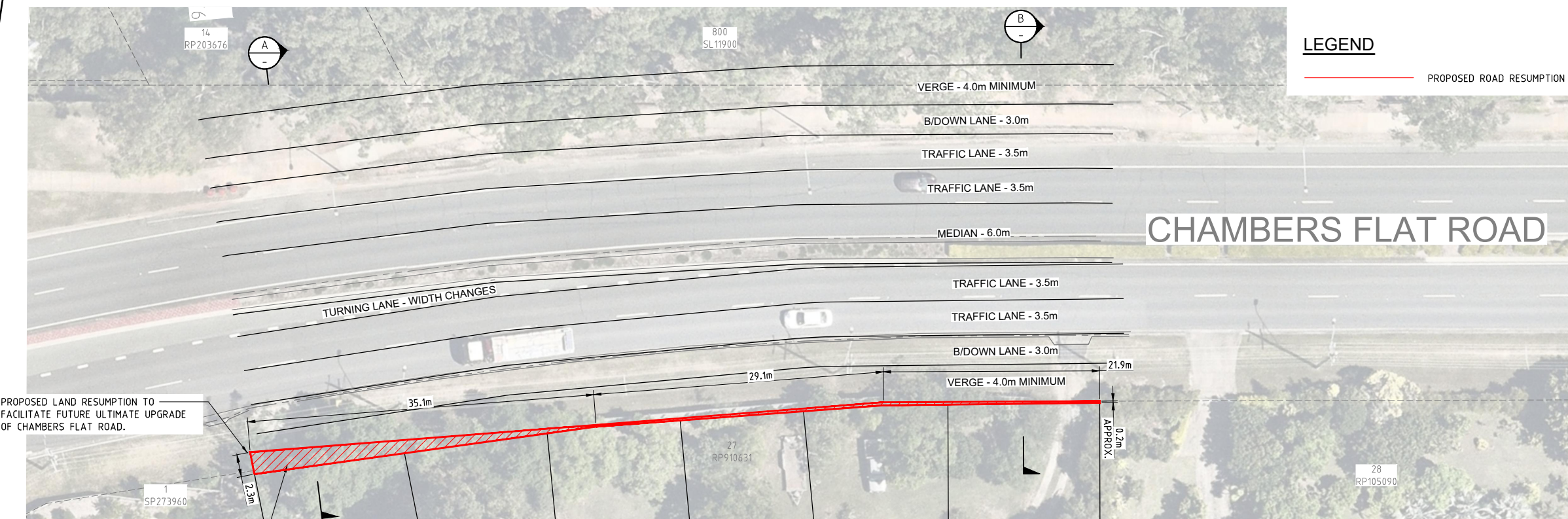
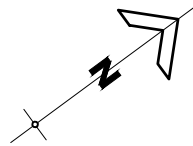

LEGEND
 — PROPOSED ROAD RESUMPTION

CHAMBERS FLAT ROAD

PROPOSED LAND RESUMPTION TO FACILITATE FUTURE ULTIMATE UPGRADE OF CHAMBERS FLAT ROAD.

ROAD RESUMPTION TO FOLLOW SAME PROJECTION AS SOUTHERN DEVELOPMENT ROAD RESUMPTION (LOT 1 ON SP273960)

CHAMBERS FLAT ROAD WIDENING CONCEPT PLAN

SCALE 1 : 250 (FULL SIZE)

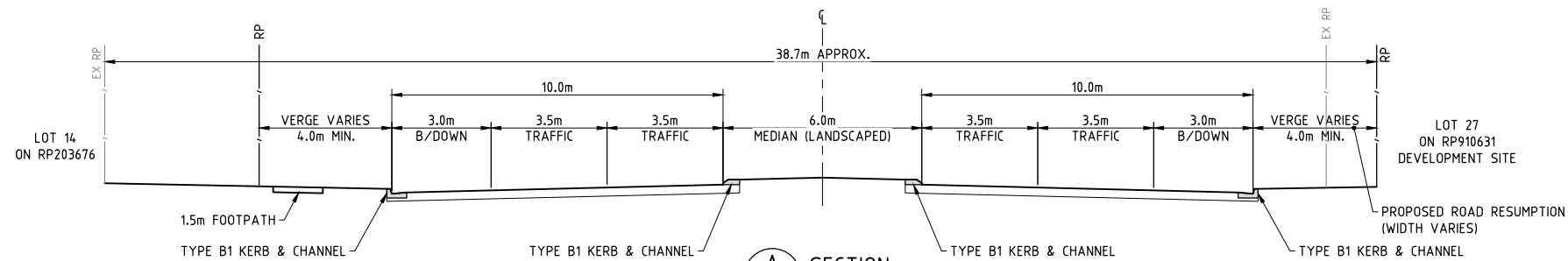

A SECTION
 SCALE 1:100

SCALE 1 : 100 (FULL SIZE)

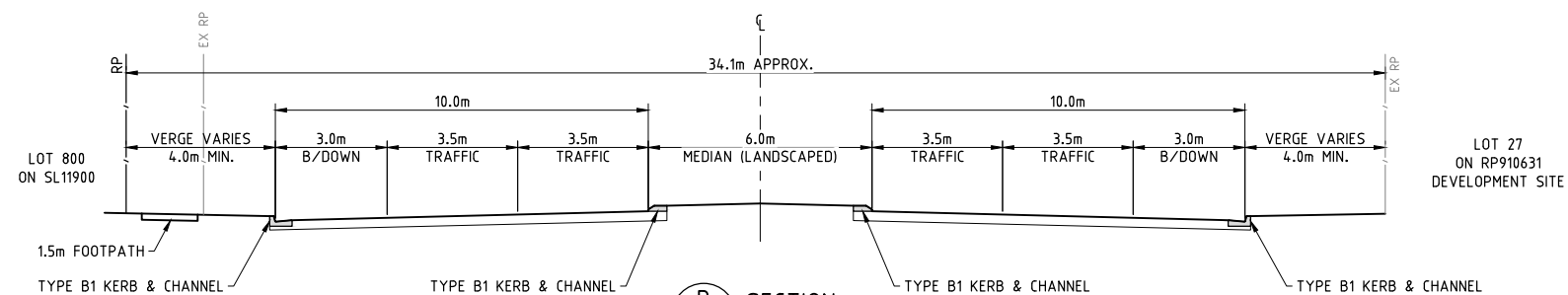

B SECTION
 SCALE 1:100

SCALE 1 : 100 (FULL SIZE)

PROPOSED RESIDENTIAL SUBDIVISION

LOT 27 ON RP910631, 224 CHAMBERS FLAT ROAD, WATERFORD WEST

FOR
 GAFSTEV PTY LTD

A1 ORIGINAL SIZE BEFORE REDUCTION

VER.	DESCRIPTION	DATE
A	ORIGINAL ISSUE	10-10-23

COPYRIGHT (C)
 This drawing is copyright and the property of Burchills Engineering Solutions. It must not be retained, copied or used without the authority of Burchills Engineering Solutions.
DISCLAIMER
 This drawing and its contents are electronically generated, are confidential and may only be used for the purpose for which they were intended. Burchills Engineering Solutions will not accept responsibility for any consequences arising from the use of the drawing for other than its intended purpose or where the drawing has been altered, amended or changed either manually or electronically by any third party.
NOTE
 This is an uncontrolled document issued for information purposes only, unless the checked sections are signed or completed. Figured dimensions take precedence over scale. Do not scale reduced size drawings. Verify dimensions prior to commencing any on-site or off-site works or fabrication.



GOLD COAST | BRISBANE | TOOWOOMBA
 IPSWICH | MORETON BAY
 PHONE: +61 7 5509 6400
 FAX: +61 7 5509 6411
 EMAIL: ADMIN@BURCHILLS.COM.AU
 COOTE BURCHILLS ENGINEERING PTY LTD
 ABN 76 166 942 365

PROJECT:
224 CHAMBERS FLAT ROAD

DRAWING TITLE:
CHAMBERS FLAT ROAD WIDENING CONCEPT PLAN & SECTIONS

DEVEL. APPLIC. No. : RL57/2021	DATE : 10-10-23
PROJECT LEADER : ROBERTO DI FABIO	
DESIGNER : L.D.L.	
DRAFTSPERSON : L.D.L.	
CHECKED : ROBERTO DI FABIO	
APPROVED FOR AND ON BEHALF OF BURCHILLS ENGINEERING SOLUTIONS ABN 76 166 942 365	
RPEQ No. :	
SCALE : AS NOTED	DATUM : AHD
PROJECT No. : BE210215-01	DRAWING No. : C102
	VERSION : A

PROPOSED RESIDENTIAL SUBDIVISION

LOT 27 ON RP910631, 224 CHAMBERS FLAT ROAD, WATERFORD WEST

FOR

GAFSTEV PTY LTD

A1 ORIGINAL SIZE BEFORE REDUCTION

VER.	DESCRIPTION	DATE
A	ORIGINAL ISSUE	10-10-23

COPYRIGHT (C)
This drawing is copyright and the property of Burchills Engineering Solutions. If must not be retained, copied or used without the authority of Burchills Engineering Solutions.

DISCLAIMER
This drawing and its contents are electronically generated, are confidential and may only be used for the purpose for which they were intended. Burchills Engineering Solutions will not accept responsibility for any consequences arising from the use of the drawing for other than its intended purpose or where the drawing has been altered, amended or changed either manually or electronically by any third party.

NOTE
This is an uncontrolled document issued for information purposes only, unless the checked sections are signed or completed. Figure dimensions take precedence over scale. Do not scale reduced size drawings. Verify dimensions prior to commencing any on-site or off-site works or fabrication.

BURCHILLS ENGINEERING SOLUTIONS

GOLD COAST | BRISBANE | TOOWOOMBA
IPSWICH | MORETON BAY
PHONE: +61 7 5509 6400
FAX: +61 7 5509 6411
EMAIL: ADMIN@BURCHILLS.COM.AU
COOTE BURCHILLS ENGINEERING PTY LTD
ABN 76 166 942 365

PROJECT:
224 CHAMBERS FLAT ROAD

DRAWING TITLE:
PRELIMINARY EARTHWORKS LAYOUT PLAN

DEVEL. APPLIC. No. : RL/57/2021	DATE : 10-10-23
PROJECT LEADER : ROBERTO DI FABIO	
DESIGNER : L.D.L.	
DRAFTSPERSON : L.D.L.	
CHECKED : ROBERTO DI FABIO	
APPROVED FOR AND ON BEHALF OF BURCHILLS ENGINEERING SOLUTIONS ABN 76 166 942 365	
RPEQ No. :	
SCALE : AS NOTED	DATUM : AHD FULL SIZE : A1
PROJECT No. : BE210215-01	DRAWING No. : C200 VERSION: A

LEGEND

- - - -15.0 - - - EXISTING SURFACE CONTOURS
- 15.0— DESIGN SURFACE CONTOURS
- - - - - EXISTING LOT BOUNDARY
- - - - - EXISTING ROAD CONTROL LINE
- - - - - EXISTING KERB
- - - - - EXISTING RETAINING WALL
- - - - - EXISTING SEWER MAIN
- - - - - PROPOSED LOT BOUNDARY
- - - - - PROPOSED EASEMENT
- - - - - PROPOSED ROAD CONTROL LINE
- - - - - PROPOSED KERB (TYPE M3)
- - - - - PROPOSED RETAINING WALL
- █ EARTHWORKS AREA OF FILL
- █ EARTHWORKS AREA OF CUT
- █ DEVELOPMENT SITE BOUNDARY

BULK EARTHWORKS SUMMARY

STRUCTURAL FILLING		
AREA	NETT SOLID FILL	
OVERALL FILLING	13,385 cu.m.	
TOTAL FILL REQUIRED	13,385 cu.m.	
EXCAVATION		
AREA	NETT CUT	incl. COMPACTION FACTOR (0.85)
OVERALL EXCAVATION	2,582 cu.m.	2,195 cu.m.
TOTAL CUT	2,582 cu.m.	2,195 cu.m.

SUMMARY:
13,385 cu.m. - 2,195 cu.m. = 11,190 cu.m. IMPORT REQUIRED FOR COMPLETION OF EARTHWORKS.
NO ALLOWANCE HAS BEEN MADE FOR TOPSOIL STRIP REPLACEMENT.
MINIMUM PAD LEVEL = RL15.100 (14.600m Q₁₀₀ LEVEL + 0.5m FREEBOARD)

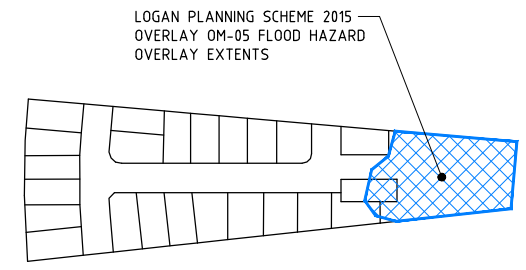

L.C.C. FLOOD OVERLAY MAP

SCALE 1 : 2000 (FULL SIZE)

FLOOD STORAGE CALCULATIONS:

- DEFINED FLOOD LEVEL RL 14.600
- EXISTING FLOOD STORAGE: 7,085m³ (FROM 14.600m AHD TO EXISTING SURFACE WITHIN FLOOD OVERLAY EXTENT)
- PROPOSED FLOOD STORAGE: 7,089m³ (FROM 14.600m AHD TO PROPOSED SURFACE WITH FLOOD OVERLAY EXTENT)
- BULK EARTHWORKS ANALYSIS WITHIN FLOOD OVERLAY EXTENT:
- FILL 776m³ (645m³ UP TO 14.600m AHD FLOOD HAZARD OVERLAY) (130m³ FILL FROM 14.600m AHD TO FSL)
- CUT 645m³

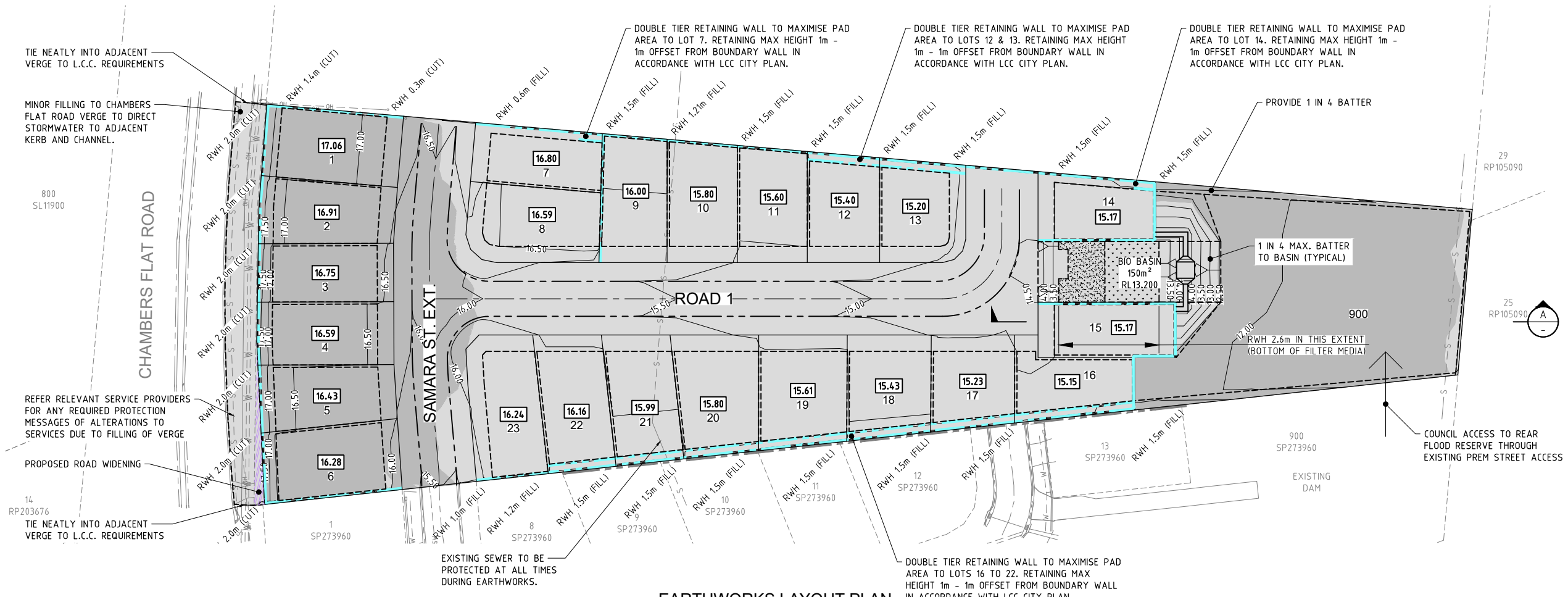

EARTHWORKS LAYOUT PLAN

SCALE 1 : 500 (FULL SIZE)

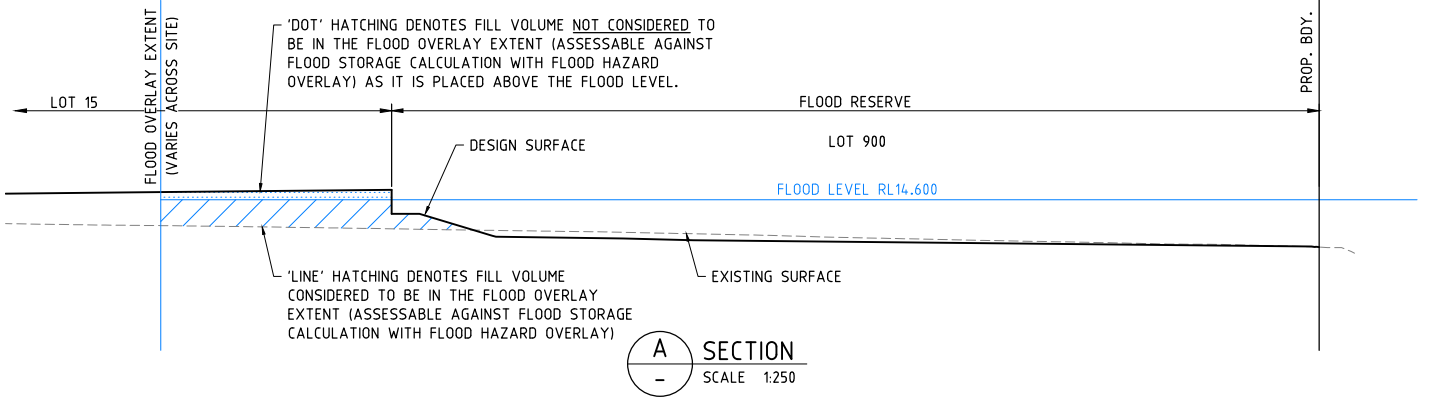

NOTE:
ALL DESIGN/SETOUT INFORMATION SHOWN ON THIS DRAWING IS AVAILABLE IN DIGITAL FORMAT FROM THE OFFICE OF THE SUPERINTENDENT UPON REQUEST BY THE CONTRACTOR.

WARNING: UNDERGROUND SERVICES:
UNDERGROUND SERVICES EXIST IN THIS VICINITY. THE CONTRACTOR IS TO CONTACT THE RELEVANT AUTHORITIES TO CONFIRM EXACT LOCATION OF SERVICES ON SITE PRIOR TO ANY EXCAVATION OR CONSTRUCTION COMMENCING.

SECTION A SCALE 1:250

PROPOSED RESIDENTIAL SUBDIVISION

LOT 27 ON RP910631, 224 CHAMBERS FLAT ROAD, WATERFORD WEST

FOR

GAFSTEV PTY LTD

A1 ORIGINAL SIZE BEFORE REDUCTION

VER.	DESCRIPTION	DATE
A	ORIGINAL ISSUE	10-10-23

COPYRIGHT ©
 This drawing is copyright and the property of Burchills Engineering Solutions. It must not be retained, copied or used without the authority of Burchills Engineering Solutions.
DISCLAIMER
 This drawing and its contents are electronically generated, are confidential and may only be used for the purpose for which they were intended. Burchills Engineering Solutions will not accept responsibility for any consequences arising from the use of the drawing for other than its intended purpose or where the drawing has been altered, amended or changed either manually or electronically by any third party.
NOTE
 This is an uncontrolled document issued for information purposes only, unless the checked sections are signed or completed. Figure dimensions take precedence over scale. Do not scale reduced size drawings. Verify dimensions prior to commencing any on-site or off-site works or fabrication.

BURCHILLS ENGINEERING SOLUTIONS

GOLD COAST | BRISBANE | TOOWOOMBA
 IPSWICH | MORETON BAY
 PHONE: +61 7 5509 6400
 FAX: +61 7 5509 6411
 EMAIL: ADMIN@BURCHILLS.COM.AU
 COOTE BURCHILLS ENGINEERING PTY LTD
 ABN 76 166 942 365

PROJECT:
224 CHAMBERS FLAT ROAD

DRAWING TITLE:
PRELIMINARY ROADWORKS AND DRAINAGE PLAN

DEVEL. APPLIC. No.: RL/57/2021	DATE: 10-10-23
PROJECT LEADER: ROBERTO DI FABIO	
DESIGNER: L.D.L.	
DRAFTSPERSON: L.D.L.	
CHECKED: ROBERTO DI FABIO	
APPROVED FOR AND ON BEHALF OF BURCHILLS ENGINEERING SOLUTIONS ABN 76 166 942 365	
RPEQ No.:	

SCALE: AS NOTED	DATUM: AHD	FULL SIZE: A1
PROJECT No.: BE210215-01	DRAWING No.: C300	VERSION: A

LEGEND

- 15.0— DESIGN SURFACE CONTOURS
- - - - - EXISTING LOT BOUNDARY
- SW - - - - - EXISTING STORMWATER
- W - - - - - EXISTING WATER
- S - - - - - EXISTING SEWER
- OH - - - - - EXISTING OVERHEAD ELECTRIC
- UE - - - - - EXISTING UNDERGROUND ELECTRIC
- C - - - - - EXISTING COMMS
- - - - - EXISTING LOT BOUNDARY
- - - - - EXISTING ROAD CONTROL LINE
- - - - - EXISTING KERB
- - - - - PROPOSED LOT BOUNDARY
- - - - - PROPOSED EASEMENT
- - - - - PROPOSED STORMWATER
- - - - - PROPOSED STORMWATER SWALE
- - - - - PROPOSED WATER
- - - - - PROPOSED SEWER
- - - - - PROPOSED ROAD CONTROL LINE
- - - - - PROPOSED KERB (TYPE M3)
- - - - - PROPOSED RETAINING WALL
- - - - - DEVELOPMENT SITE BOUNDARY
- - - - - PROPOSED ASPHALT PAVEMENT
- - - - - PROPOSED BASIN DRIVEWAY

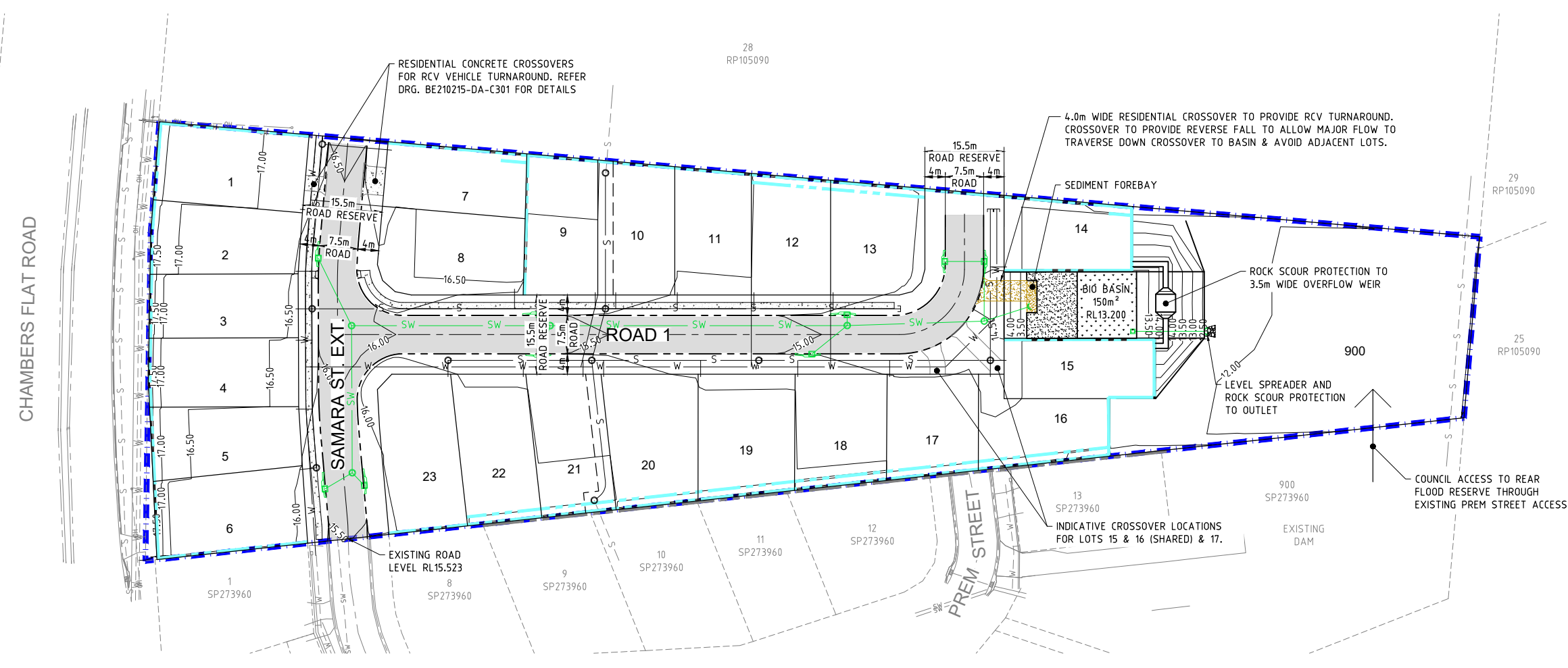

ROADWORKS AND DRAINAGE LAYOUT PLAN

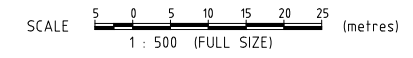

NOTE:
 ALL DESIGN/SETOUT INFORMATION SHOWN ON THIS DRAWING IS AVAILABLE IN DIGITAL FORMAT FROM THE OFFICE OF THE SUPERINTENDENT UPON REQUEST BY THE CONTRACTOR.

WARNING: UNDERGROUND SERVICES:
 UNDERGROUND SERVICES EXIST IN THIS VICINITY. THE CONTRACTOR IS TO CONTACT THE RELEVANT AUTHORITIES TO CONFIRM EXACT LOCATION OF SERVICES ON SITE PRIOR TO ANY EXCAVATION OR CONSTRUCTION COMMENCING.

PROPOSED RESIDENTIAL SUBDIVISION

LOT 27 ON RP910631, 224 CHAMBERS FLAT ROAD, WATERFORD WEST

FOR

GAFSTEV PTY LTD

A1 ORIGINAL SIZE BEFORE REDUCTION

VER.	DESCRIPTION	DATE
A	ORIGINAL ISSUE	10-10-23

COPYRIGHT (C)
This drawing is copyright and the property of Burchills Engineering Solutions. It must not be retained, copied or used without the authority of Burchills Engineering Solutions.

DISCLAIMER
This drawing and its contents are electronically generated, are confidential and may only be used for the purpose for which they were intended. Burchills Engineering Solutions will not accept responsibility for any consequences arising from the use of the drawing for other than its intended purpose or where the drawing has been altered, amended or changed either manually or electronically by any third party.

NOTE
This is an uncontrolled document issued for information purposes only, unless the checked sections are signed or completed. Figured dimensions take precedence over scale. Do not scale reduced size drawings. Verify dimensions prior to commencing any on-site or off-site works or fabrication.



GOLD COAST | BRISBANE | TOOWOOMBA
IPSWICH | MORETON BAY
PHONE: +61 7 5509 6400
FAX: +61 7 5509 6411
EMAIL: ADMIN@BURCHILLS.COM.AU
COOTE Burchills Engineering Pty Ltd
ABN 76 166 942 365

PROJECT:

224 CHAMBERS FLAT ROAD

DRAWING TITLE:

PRELIMINARY ROAD LONGITUDINAL SECTIONS

DEVEL. APPLIC. No.: RL/57/2021 DATE: 10-10-23

PROJECT LEADER: ROBERTO DI FABIO

DESIGNER: L.D.L.

DRAFTSPERSON: L.D.L.

CHECKED: ROBERTO DI FABIO

APPROVED FOR AND ON BEHALF OF Burchills Engineering Solutions ABN 76 166 942 365

RPEQ No.:

SCALE: AS NOTED DATUM: AHD FULL SIZE: A1

PROJECT No.: DRAWING No.: VERSION:

BE210215-01 C310 A

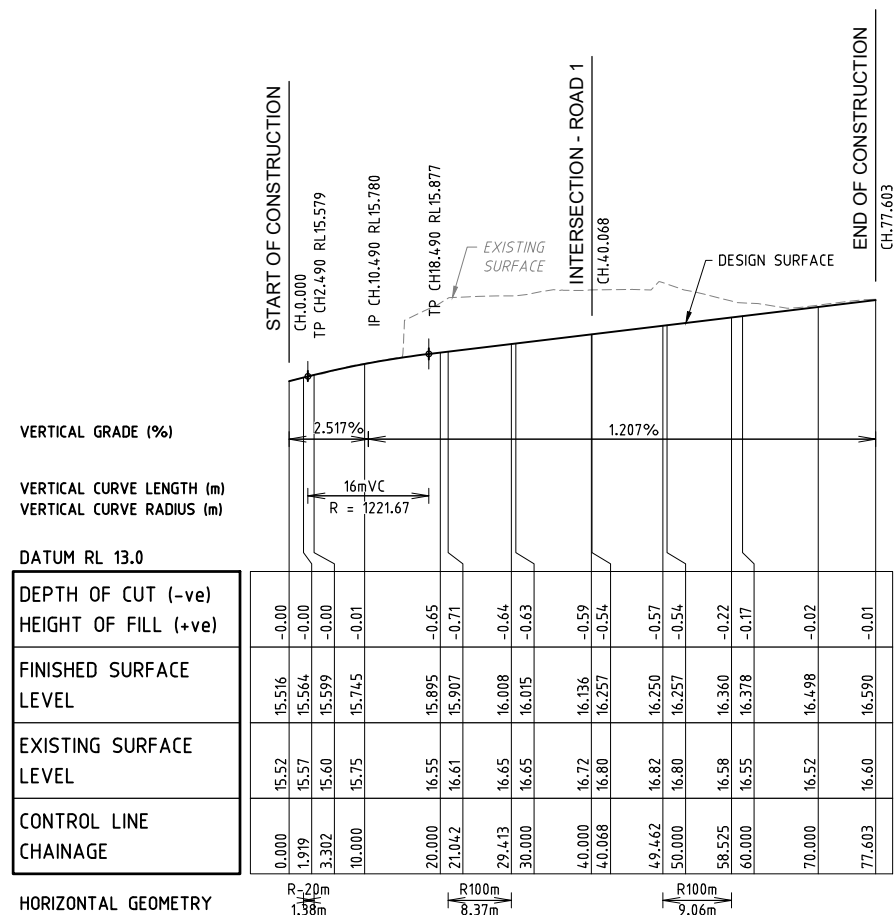

LONGITUDINAL SECTION - SAMARA ST. EXT.

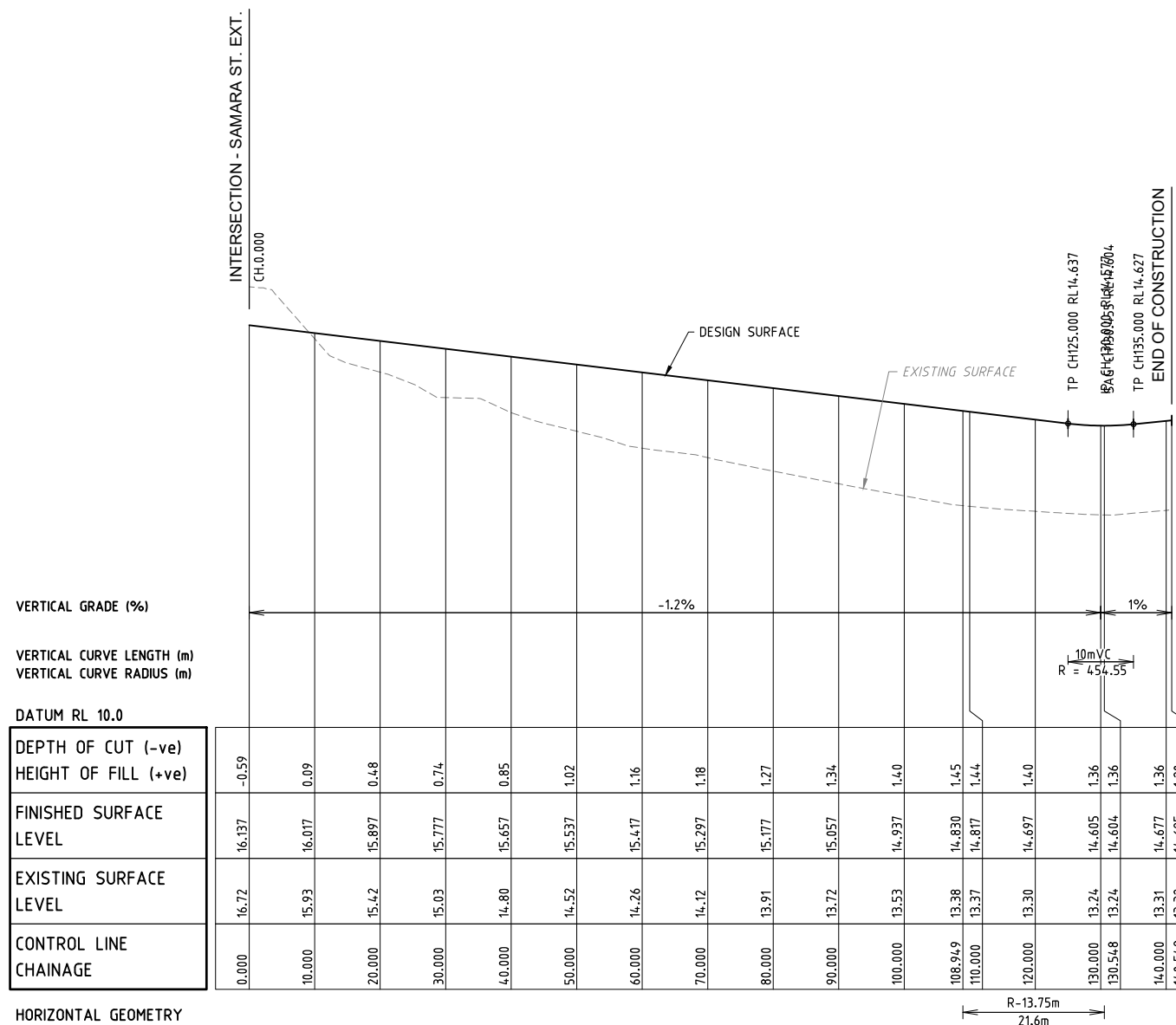
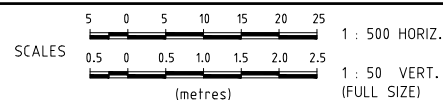

LONGITUDINAL SECTION - ROAD 1

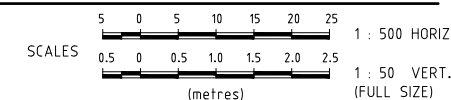

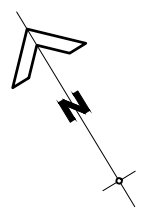

PROPOSED RESIDENTIAL SUBDIVISION

LOT 27 ON RP910631, 224 CHAMBERS FLAT ROAD, WATERFORD WEST

FOR

GAFSTEV PTY LTD

A1 ORIGINAL SIZE BEFORE REDUCTION

VER.	DESCRIPTION	DATE
A	ORIGINAL ISSUE	10-10-23

COPYRIGHT (C)
 This drawing is copyright and the property of Burchills Engineering Solutions. It must not be retained, copied or used without the authority of Burchills Engineering Solutions.

DISCLAIMER
 This drawing and its contents are electronically generated, are confidential and may only be used for the purpose for which they were intended. Burchills Engineering Solutions will not accept responsibility for any consequences arising from the use of the drawing for other than its intended purpose or where the drawing has been altered, amended or changed either manually or electronically by any third party.

NOTE
 This is an uncontrolled document issued for information purposes only, unless the checked sections are signed or completed. Figured dimensions take precedence over scale. Do not scale reduced size drawings. Verify dimensions prior to commencing any on-site or off-site works or fabrication.



GOLD COAST | BRISBANE | TOOWOOMBA
 IPSWICH | MORETON BAY
 PHONE: +61 7 5509 6400
 FAX: +61 7 5509 6411
 EMAIL: ADMIN@BURCHILLS.COM.AU
COOTE BURCHILLS ENGINEERING PTY LTD
 ABN 76 166 942 365

PROJECT:
224 CHAMBERS FLAT ROAD

DRAWING TITLE:
PRELIMINARY BIO-DETENTION BASIN LAYOUT PLAN

DEVEL. APPLIC. No.: RL5/2021 DATE: 10-10-23

PROJECT LEADER: ROBERTO DI FABIO

DESIGNER: L.D.L.

DRAFTSPERSON: L.D.L.

CHECKED: ROBERTO DI FABIO

APPROVED FOR AND ON BEHALF OF BURCHILLS ENGINEERING SOLUTIONS ABN 76 166 942 365

RPEQ No.:

SCALE: AS NOTED DATUM: AHD FULL SIZE: A1

PROJECT No.: DRAWING No.: VERSION:

BE210215-01 C450 A

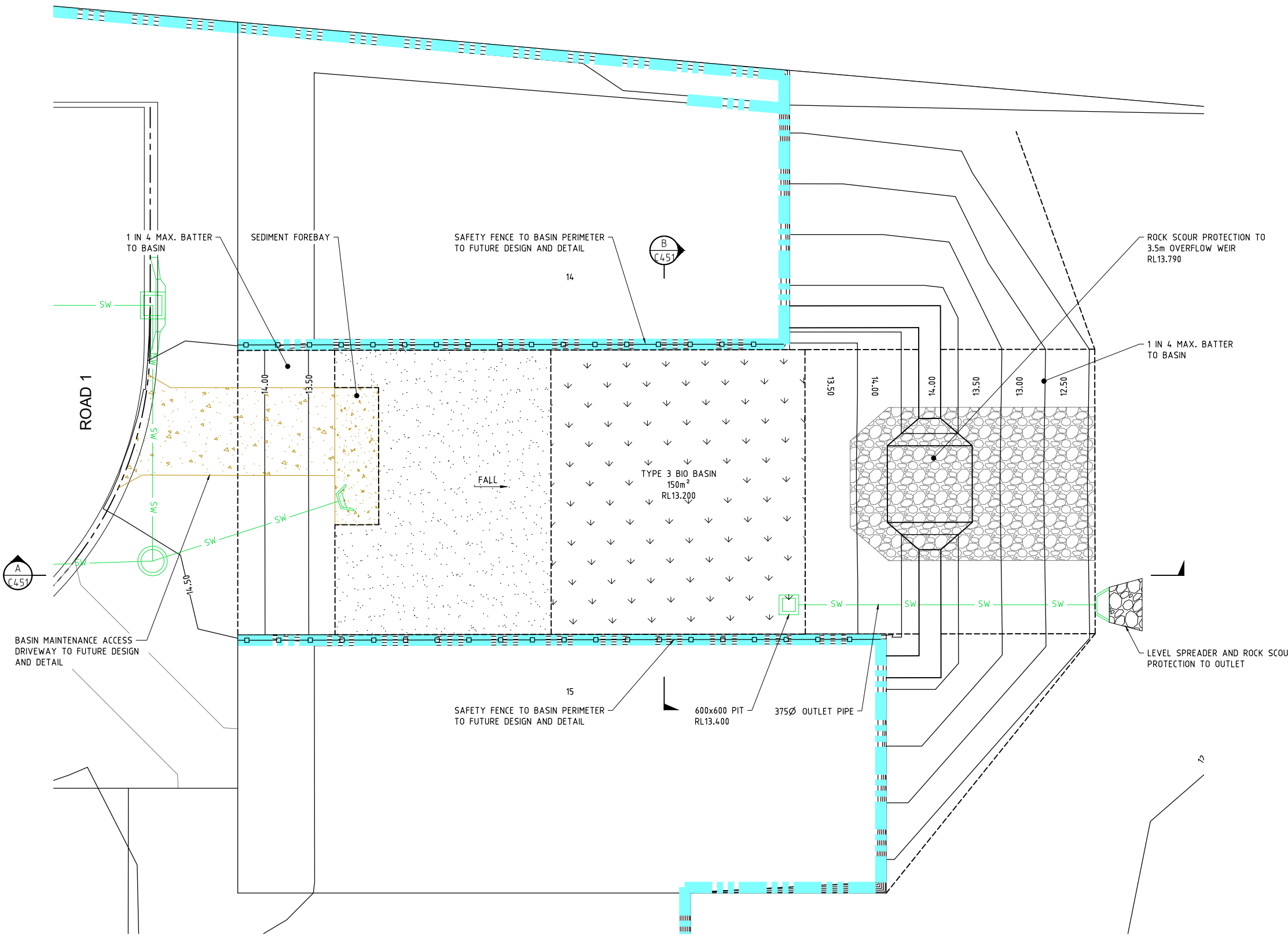

PRELIMINARY BIO-DETENTION BASIN LAYOUT PLAN

SCALE 1:100 (FULL SIZE) (metres)

PROPOSED RESIDENTIAL SUBDIVISION

LOT 27 ON RP910631, 224 CHAMBERS FLAT ROAD, WATERFORD WEST

FOR

GAFSTEV PTY LTD

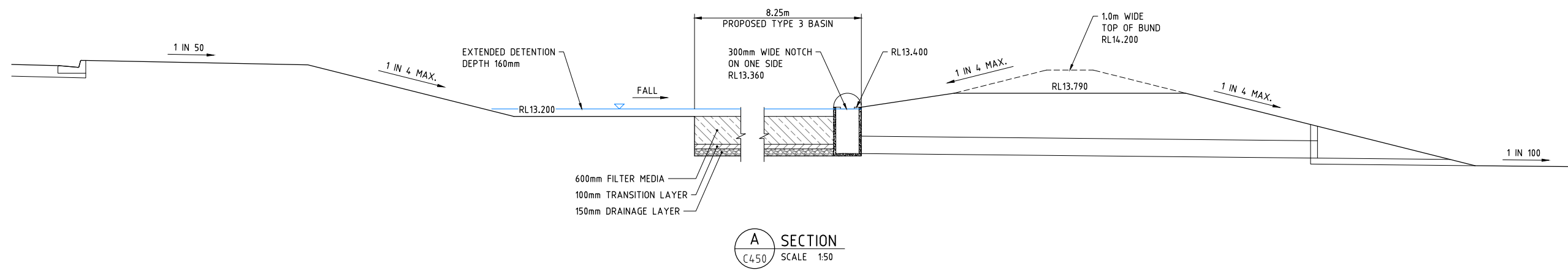

A SECTION
SCALE 1:50

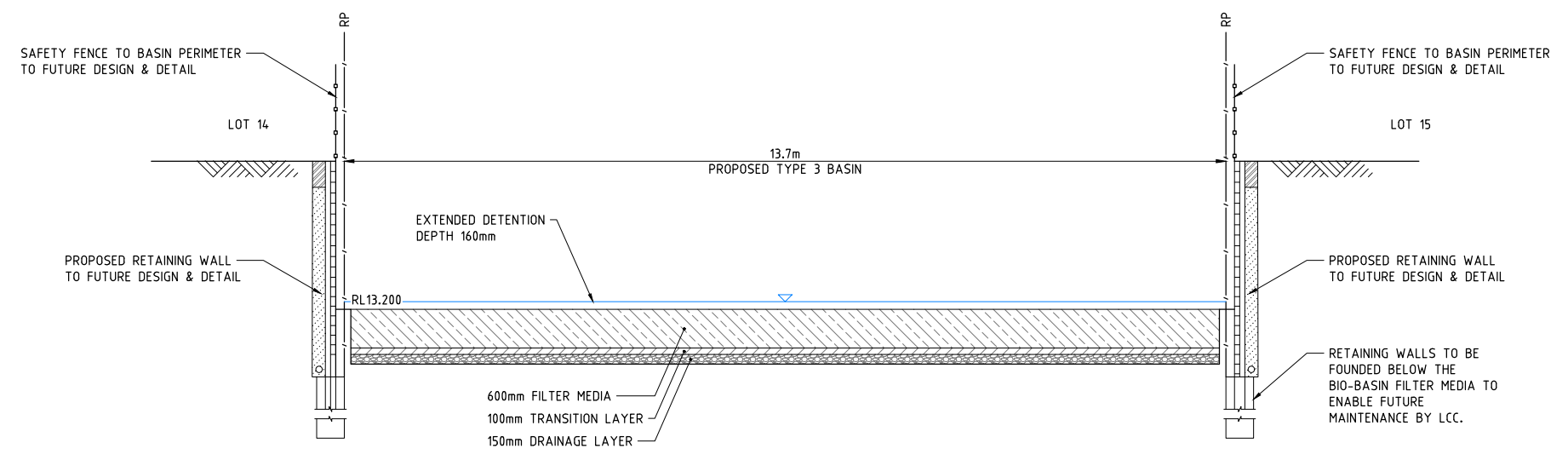

B SECTION
SCALE 1:50

A1 ORIGINAL SIZE BEFORE REDUCTION

VER.	DESCRIPTION	DATE
A	ORIGINAL ISSUE	10-10-23

COPYRIGHT ©
This drawing is copyright and the property of Burchills Engineering Solutions. It must not be retained, copied or used without the authority of Burchills Engineering Solutions.
DISCLAIMER
This drawing and its contents are electronically generated, are confidential and may only be used for the purpose for which they were intended. Burchills Engineering Solutions will not accept responsibility for any consequences arising from the use of the drawing for other than its intended purpose or where the drawing has been altered, amended or changed either manually or electronically by any third party.
NOTE
This is an uncontrolled document issued for information purposes only, unless the checked sections are signed or completed. Figured dimensions take precedence over scale. Do not scale reduced size drawings. Verify dimensions prior to commencing any on-site or off-site works or fabrication.

BURCHILLS ENGINEERING SOLUTIONS
GOLD COAST | BRISBANE | TOOWOOMBA
IPSWICH | MORETON BAY
PHONE: +61 7 5509 6400
FAX: +61 7 5509 6411
EMAIL: ADMIN@BURCHILLS.COM.AU
COOTE BURCHILLS ENGINEERING PTY LTD
ABN 76 166 942 365

PROJECT:
224 CHAMBERS FLAT ROAD

DRAWING TITLE:
BIO-DETENTION BASIN SECTIONS

DEVEL. APPLIC. No. : RL/57/2021	DATE : 10-10-23
PROJECT LEADER : ROBERTO DI FABIO	
DESIGNER : L.D.L.	
DRAFTSPERSON : L.D.L.	
CHECKED : ROBERTO DI FABIO	
APPROVED FOR AND ON BEHALF OF BURCHILLS ENGINEERING SOLUTIONS ABN 76 166 942 365	
RPEQ No. :	
SCALE : AS NOTED	DATUM : AHD
PROJECT No. : BE210215-01	DRAWING No. : C451
	VERSION: A

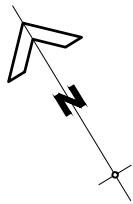

LEGEND

- 15.0— DESIGN SURFACE CONTOURS
- SW - - - - EXISTING STORMWATER
- W - - - - EXISTING WATER
- S - - - - EXISTING SEWER
- - - - EXISTING KERB
- PROPOSED LOT BOUNDARY
- - - - PROPOSED EASEMENT
- - - - PROPOSED KERB (TYPE M3)
- SW — PROPOSED STORMWATER
- W — PROPOSED WATER
- S — PROPOSED SEWER
- ■ — DEVELOPMENT SITE BOUNDARY
- DEVELOPMENT SITE

PROPOSED RESIDENTIAL SUBDIVISION

LOT 27 ON RP910631, 224 CHAMBERS FLAT ROAD, WATERFORD WEST

FOR

GAFSTEV PTY LTD

A1 ORIGINAL SIZE BEFORE REDUCTION

VER.	DESCRIPTION	DATE
A	ORIGINAL ISSUE	10-10-23

COPYRIGHT (C)
 This drawing is copyright and the property of Burchills Engineering Solutions. It must not be retained, copied or used without the authority of Burchills Engineering Solutions.
DISCLAIMER
 This drawing and its contents are electronically generated, are confidential and may only be used for the purpose for which they were intended. Burchills Engineering Solutions will not accept responsibility for any consequences arising from the use of the drawing for other than its intended purpose or where the drawing has been altered, amended or changed either manually or electronically by any third party.
NOTE
 This is an uncontrolled document issued for information purposes only, unless the checked sections are signed or completed. Figured dimensions take precedence over scale. Do not scale reduced size drawings. Verify dimensions prior to commencing any on-site or off-site works or fabrication.

BURCHILLS ENGINEERING SOLUTIONS
 GOLD COAST | BRISBANE | TOOWOOMBA
 IPSWICH | MORETON BAY
 PHONE: +61 7 5509 6400
 FAX: +61 7 5509 6411
 EMAIL: ADMIN@BURCHILLS.COM.AU
 COOTE BURCHILLS ENGINEERING PTY LTD
 ABN 76 166 942 365

PROJECT:
224 CHAMBERS FLAT ROAD

DRAWING TITLE:
PRELIMINARY SERVICES LAYOUT PLAN

DEVEL. APPLIC. No. : RL/57/2021	DATE : 10-10-23
PROJECT LEADER : ROBERTO DI FABIO	
DESIGNER : L.D.L.	
DRAFTSPERSON : L.D.L.	
CHECKED : ROBERTO DI FABIO	
APPROVED FOR AND ON BEHALF OF BURCHILLS ENGINEERING SOLUTIONS ABN 76 166 942 365	
RPEQ No. :	
SCALE : AS NOTED	DATUM : AHD
PROJECT No. : BE210215-01	DRAWING No. : C800
	VERSION : A

CONTRACTOR TO OBTAIN QUOTATION FROM LOGAN WATER TO ARRANGE FOR DECOMMISSIONING OF WATER SERVICE AND MAIN TO DEVELOPMENT. (FIND EXISTING SERVICE & METER ON SURVEY AND POINT TO IT)

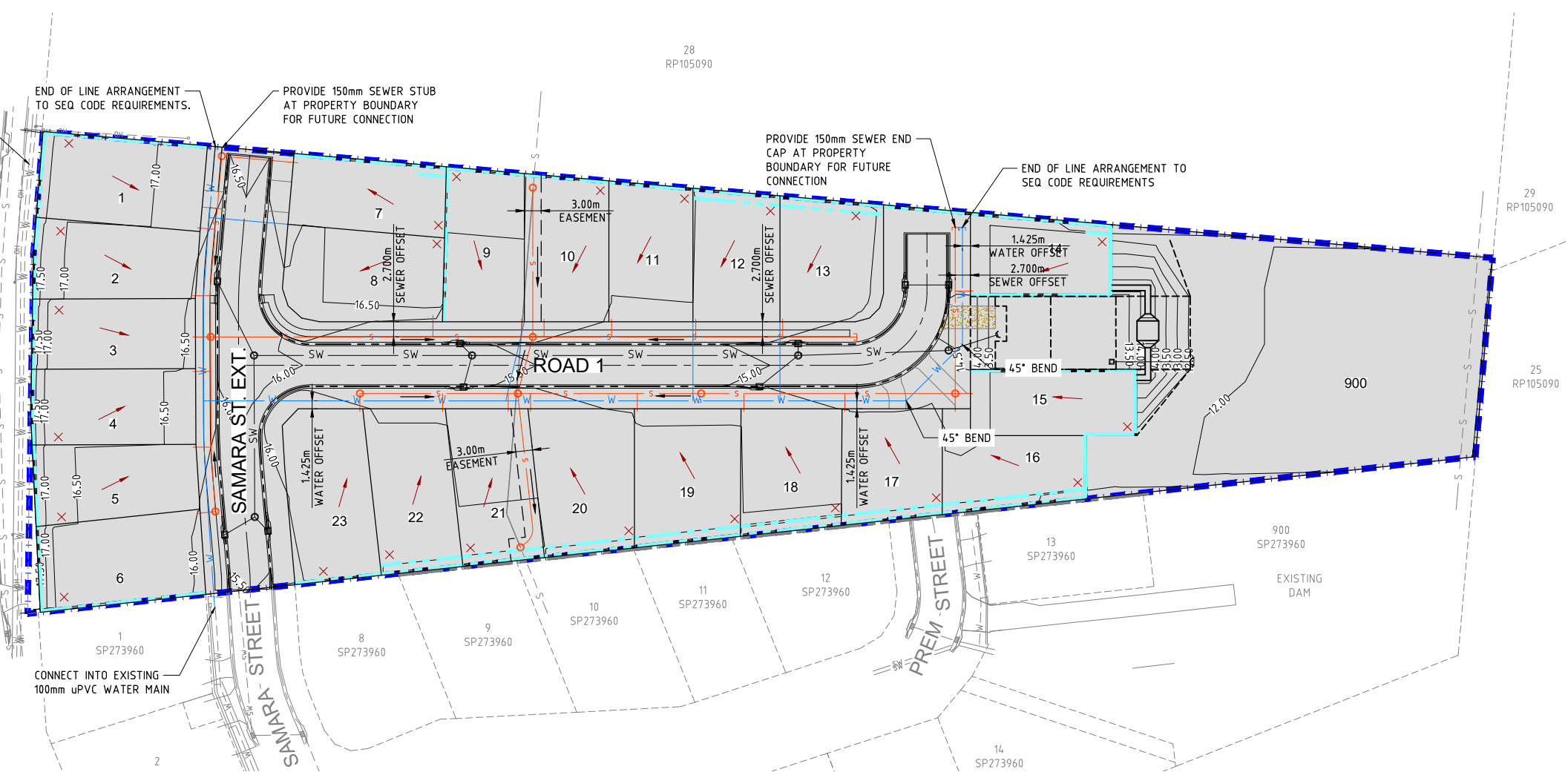

NOTE:
 ALL DESIGN/SETOUT INFORMATION SHOWN ON THIS DRAWING IS AVAILABLE IN DIGITAL FORMAT FROM THE OFFICE OF THE SUPERINTENDENT UPON REQUEST BY THE CONTRACTOR.

WARNING: UNDERGROUND SERVICES:
 UNDERGROUND SERVICES EXIST IN THIS VICINITY. THE CONTRACTOR IS TO CONTACT THE RELEVANT AUTHORITIES TO CONFIRM EXACT LOCATION OF SERVICES ON SITE PRIOR TO ANY EXCAVATION OR CONSTRUCTION COMMENCING.

CONCEPT SERVICES LAYOUT PLAN
 SCALE 1 : 500 (FULL SIZE)