

Development Opportunity for 7 SDA Villas – Loganlea Qld.



Lot 101 Maywood St. Loganlea - \$1,500,000.00

Vacant land for 7 Villas, which are SDA approved. Approx. 1,305.1m2 excluding internal road

Consisting of Unit 8 to 10 & Unit 26 to 29 on the Logan City Council Approved Plan Of Development.

The buyer needs to choose categories to prepare and lodge BA.

All 7 are under one title and can have 7 separate titles.

Please Note: This information has been provided by the seller, Lion Realty & Lion Land Marketing accepts no liability or responsibility for any errors or omissions occurring in this advertisement. Buyers are advised to do their own investigation.

LION
LAND MARKETING

Klaus 0409 496 066
Klaus@lionlandmarketing.com.au

Development Opportunity for 7 SDA Villas – Loganlea Qld.

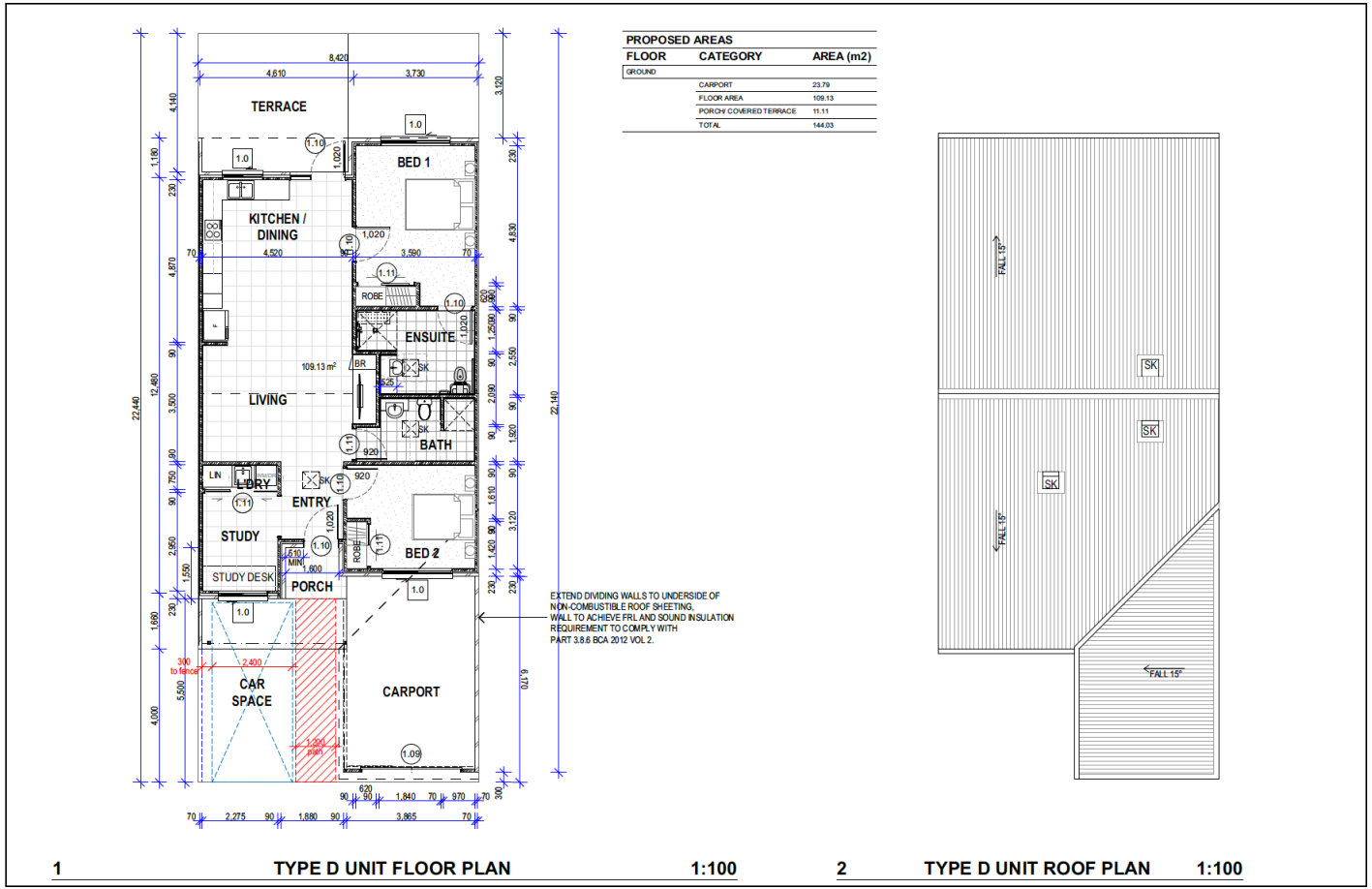

Stage 3: 7 townhouses.

Application over:

Development permits required:

'Pearls on Maywood' over parent lot created as a result of Stage 2

Material Change of Use (7 townhouses) – extension to existing multiple dwelling development.

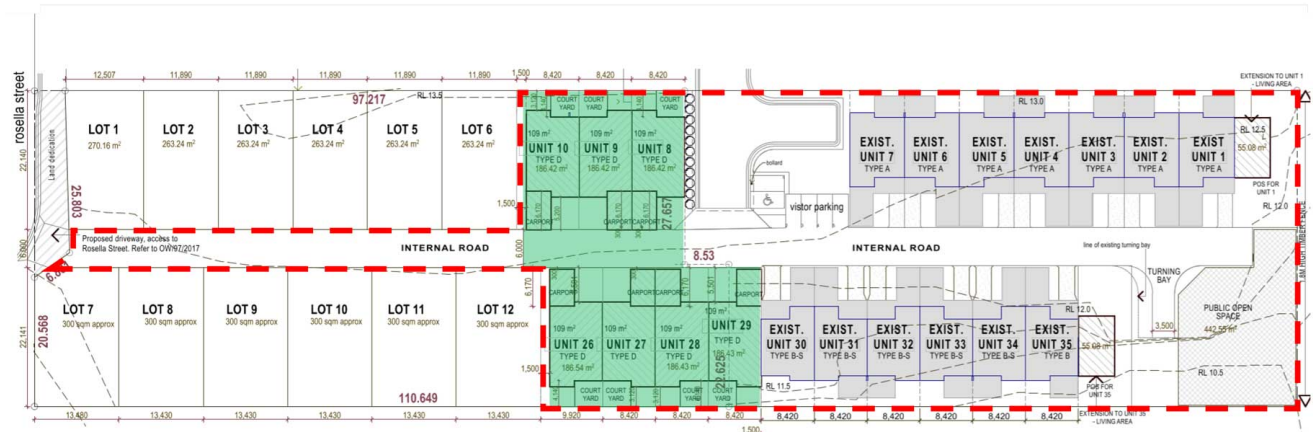

Legend:
 Green = Stage
 Red dash = Property boundary

Density: Total area = 6531.48m²
 Total number of units & equivalent dwellings (ED) =
 7 x Type A = 3x bed = (7 ED)
 7 x Type D = 2x bed = (4.9 ED)
 6 x Type B = 3x bed = (6 ED)
 TOTAL = 17.9 equivalent dwellings
Total density = 1 dwelling per 364.88m² (27.4 dwellings per hectare)

Title : Stage 3 Plan
 Date: 15/12/2020
 Plan Number: S3

LOGAN CITY COUNCIL
APPROVED PLAN OF DEVELOPMENT
 This is the approved plan of development for Development Application
 MCUI/12/2010/I

Development Opportunity for 7 SDA Villas – Loganlea Qld.

Site Location:

- ✓ Maywood Street off Rosella Street Loganlea
- ✓ Bus Stop: about 350m
- ✓ Neighbourhood Shops: about 1.1km*
- ✓ Loganlea Station: about 2.3km*
- ✓ Logan Hospital: about 3km*
- ✓ TAFE Qld. Loganlea Campus: about 3.4km*
- ✓ Loganlea High School: about 3.1km*
- ✓ Waterford West State School: about 1km*
- ✓ Waterford Shopping Plaza: about 1.1km*
- ✓ Meadowbrook Shopping Village: about 3.3km*
- ✓ Griffith University Logan Campus: about 4.7km.*
- ✓ Marsden Park Shopping centre: about 2.9km*
- ✓ Club Hotel Waterford: about 1.1km*
- ✓ Marsden High School: about 3.7km*
- ✓ Kingston College: about 4.3km*
- ✓ Groves Christian College: about 4.7km*
- ✓ Hyperdome Shopping Centre: about 9km*
- ✓ Brisbane CBD about: 30km*.
- ✓ Brisbane Airport about: 38km*
- ✓ Gold Coast: 60km*

Please note: (*Information supplied by Google Maps)

Please note: The information and details regarding this property has been provided by the seller Lion Realty & Lion Land Marketing accepts no liability or responsibility for any errors or omissions occurring in this advertisement. Detail including pricing and availability are subject to change without notice. Every reasonable effort has been made to ensure the information in this advertisement is accurate. Lion Realty or the Seller accepts no liability or responsibility for any errors or omissions occurring in or from this advertisement.

LION 
LAND MARKETING

Klaus 0409 496 066
Klaus@lionlandmarketing.com.au

LION LAND MARKETING

LION
LAND MARKETING



Klaus Ferck

The Trusted Name In Property For Over 32 Years

Principal

LION LAND MARKETING

klaus@lionrealty.com.au

M: 0409 496 066 / Ph: 07 3279 7718

www.Lionlandmarketing.com.au

LION
LAND MARKETING

1300 138 185