

DISCLOSURE PLAN

FOR PROPOSED LOT
 Currently Described as
 Part of Lot 102 on SP303506 and
 Part of Lot 14 on SP240909
 Locality: Marsden
 Local Government: Logan City

I, Kieran John McKeon of Kaymak Survey Pty Ltd
 (ACN 150160615), certify that the details on this
 sketch are correct.



This sketch has been prepared for
 WIN Housing Projects Pty Ltd

for the purposes of disclosure under the Land Sales
 Act. It is not to be used for any other purpose or by
 any other person or corporation.

All areas and dimensions are subject to survey plan
 registration and relevant authority approval.

Compaction of fill will be done in accordance with
 Australian Standard AS3798-2007 to Level 1 inspection
 and testing and the inspection of field density testing
 will be in accordance with Table 8.1 of AS3798-2007.

Dimensions, levels and contours shown are not to be
 used for building design or construction, a site survey
 is required.

Existing surface levels and features are provided by
 AJS surveys.

Proposed finished levels, contours and retaining walls
 are provided by Michael Bale and Associates.

These notes form an integral part of this plan and no
 part of this plan may be reproduced in whole or in part
 without these notes. Plan prepared in colour.

KAYMAK SURVEY PTY LTD
 ACN 150 160 615
 ABN 46 257 320 173
 1a 15a Leda Drive
 Burleigh Heads
 Queensland, 4220
 PO Box 2606
 Burleigh BC, Burleigh Waters
 QLD 4220
 www.kaymaksurvey.com.au
 07 5576 0264















DRAWN	DATE	CHECKED	DATE
KM	10/2022	KM	10/2022

AMENDMENTS

01 - Fill depths, easements, building envelopes

SCALE at A3 : 1:200
 DRAWING No: 211107-DP-L1-01
 SURVEYORS REF: 211107

LEGEND
 (This plan is prepared in colour)

-  Proposed Lot
-  Proposed Easement
-  Existing Easement
-  Existing Surface Contours (0.1m Interval)
-  Proposed Final Surface Contour (0.2m Interval)
-  Proposed Top of Batter
-  Proposed Toe of Batter
-  Proposed Retaining Wall (Max. Height 1.2m)
-  Proposed Building Envelope
-  Proposed Driveway
-  Depth of Fill 0.0m - 0.5m
-  Depth of Fill 0.5m - 1.0m
-  Depth of Fill 1.0m - 1.5m
-  Proposed Surface Level

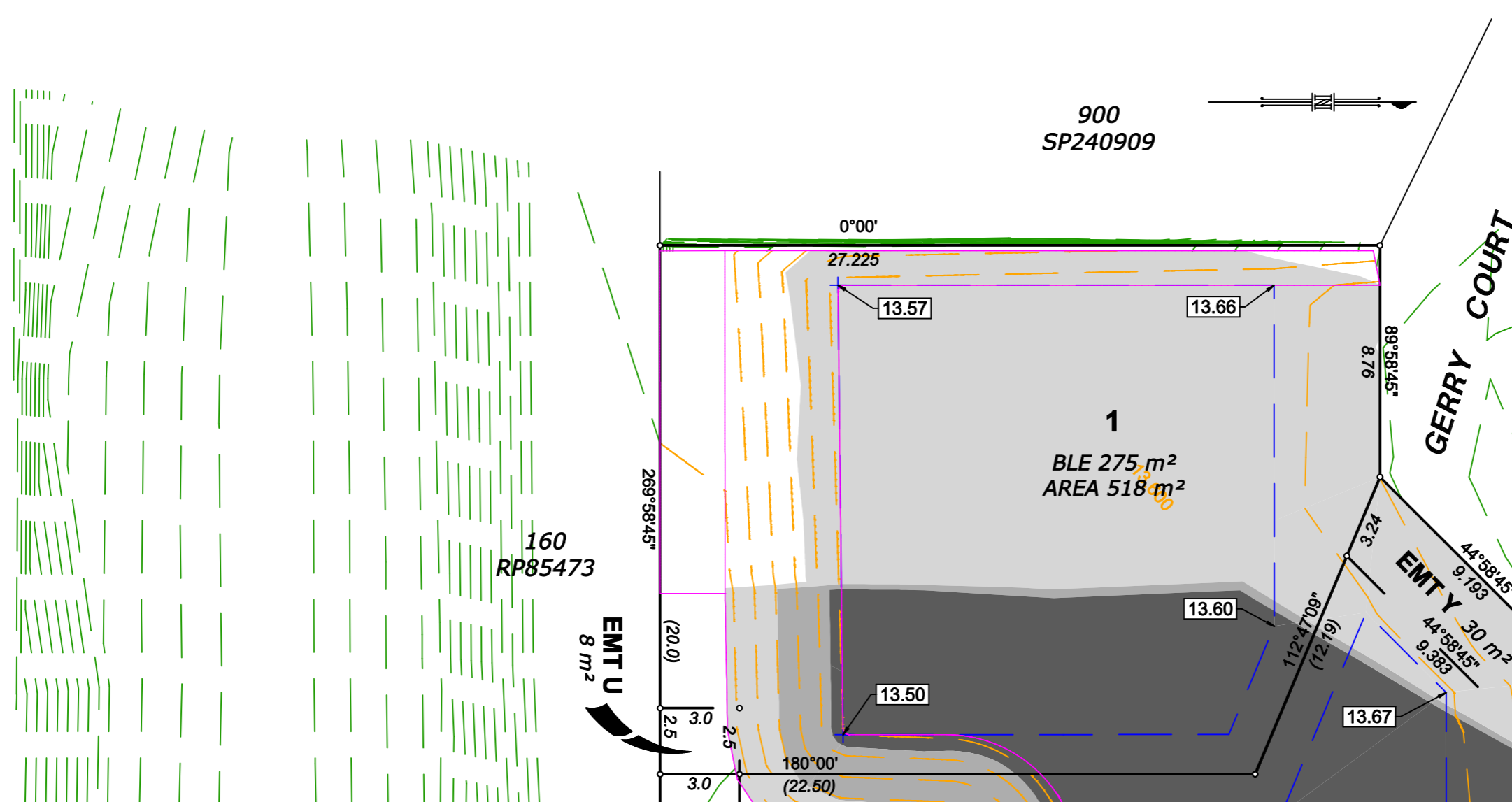

LEGEND
(This plan is prepared in colour)

- Proposed Lot
- Proposed Easement
- Existing Easement
- Existing Surface Contours (0.1m Interval)
- Proposed Final Surface Contour (0.2m Interval)
- Proposed Top of Batter
- Proposed Toe of Batter
- Proposed Retaining Wall (Max. Height 1.2m)
- Proposed Building Envelope
- Proposed Driveway
- Depth of Fill 0.0m - 0.5m
- Depth of Fill 0.5m - 1.0m
- Depth of Fill 1.0m - 1.5m
- Proposed Surface Level

900
SP240909

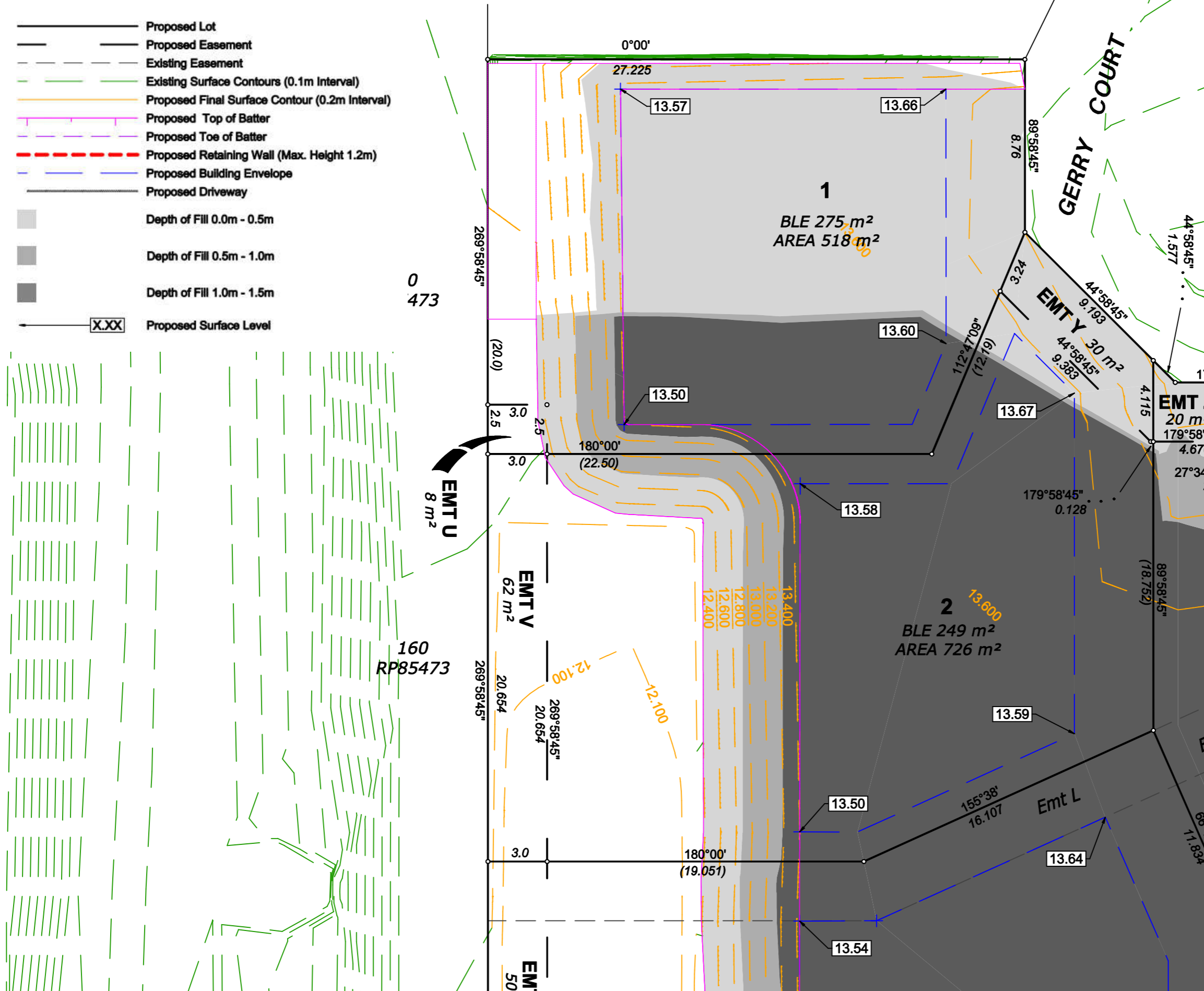

DISCLOSURE PLAN

FOR PROPOSED LOT
Currently Described as
Part of Lot 102 on SP303506
Part of Lot 14 on SP240909
Locality: Marsden
Local Government: Logan City

I, Kieran John McKeon of Kaymak Survey Pty Ltd
(ACN 150160615), certify that the details on this
sketch are correct.

Kieran McKeon

This sketch has been prepared for

WIN Housing Projects Pty Ltd

for the purposes of disclosure under the Land Sales
Act. It is not to be used for any other purpose or by
any other person or corporation.

All areas and dimensions are subject to survey plan
registration and relevant authority approval.

Compaction of fill will be done in accordance with
Australian Standard AS3798-2007 to Level 1 inspection
and testing and the inspection of field density testing
will be in accordance with Table 8.1 of AS3798-2007.

Dimensions, levels and contours shown are not to be
used for building design or construction, a site survey
is required.

Existing surface levels and features are provided by
AJS surveys.

Proposed finished levels, contours and retaining walls
are provided by Michael Bale and Associates.

These notes form an integral part of this plan and no
part of this plan may be reproduced in whole or in part
without these notes. Plan prepared in colour.

KAYMAK SURVEY PTY LTD
ACN 150 160 615
ABN 46 257 320 173
1a 15a Leda Drive
Burleigh Heads
Queensland, 4220
PO Box 2606
Burleigh BC, Burleigh Waters
QLD 4220
www.kaymaksurvey.com.au
07 5576 0264

DRAWN	DATE	CHECKED	DATE
KM	10/2022	KM	10/2022

AMENDMENTS

01 - Fill depths, easements, building envelopes

SCALE at A3 : 1:200

DRAWING No: 211107-DP-L2-01

SURVEYORS REF: 211107

DISCLOSURE PLAN

FOR PROPOSED LOT
 Currently Described as
 Part of Lot 102 on SP303506
 Part of Lot 14 on SP240909
 Locality: Marsden
 Local Government: Logan City

I, Kieran John McKeon of Kaymak Survey Pty Ltd
 (ACN 150160615), certify that the details on this
 sketch are correct.



This sketch has been prepared for
 WIN Housing Projects Pty Ltd

for the purposes of disclosure under the Land Sales
 Act. It is not to be used for any other purpose or by
 any other person or corporation.

All areas and dimensions are subject to survey plan
 registration and relevant authority approval.

Compaction of fill will be done in accordance with
 Australian Standard AS3798-2007 to Level 1 inspection
 and testing and the inspection of field density testing
 will be in accordance with Table 8.1 of AS3798-2007.

Dimensions, levels and contours shown are not to be
 used for building design or construction, a site survey
 is required.

Existing surface levels and features are provided by
 AIS surveys.

Proposed finished levels, contours and retaining walls
 are provided by Michael Bale and Associates.

These notes form an integral part of this plan and no
 part of this plan may be reproduced in whole or in part
 without these notes. Plan prepared in colour.

KAYMAK SURVEY PTY LTD
 ACN 150 160 615
 ABN 46 257 320 173
 1a 15a Leda Drive
 Burleigh Heads
 Queensland, 4220
 PO Box 2606
 Burleigh BC, Burleigh Waters
 QLD 4220
 www.kaymaksurvey.com.au
 07 5576 0264

DRAWN	DATE	CHECKED	DATE
KM	10/2022	KM	10/2022

AMENDMENTS
 01 - Fill depths, easements, building envelopes

SCALE at A3 : 1:200
 DRAWING No: 211107-DP-L3-01
 SURVEYORS REF: 211107

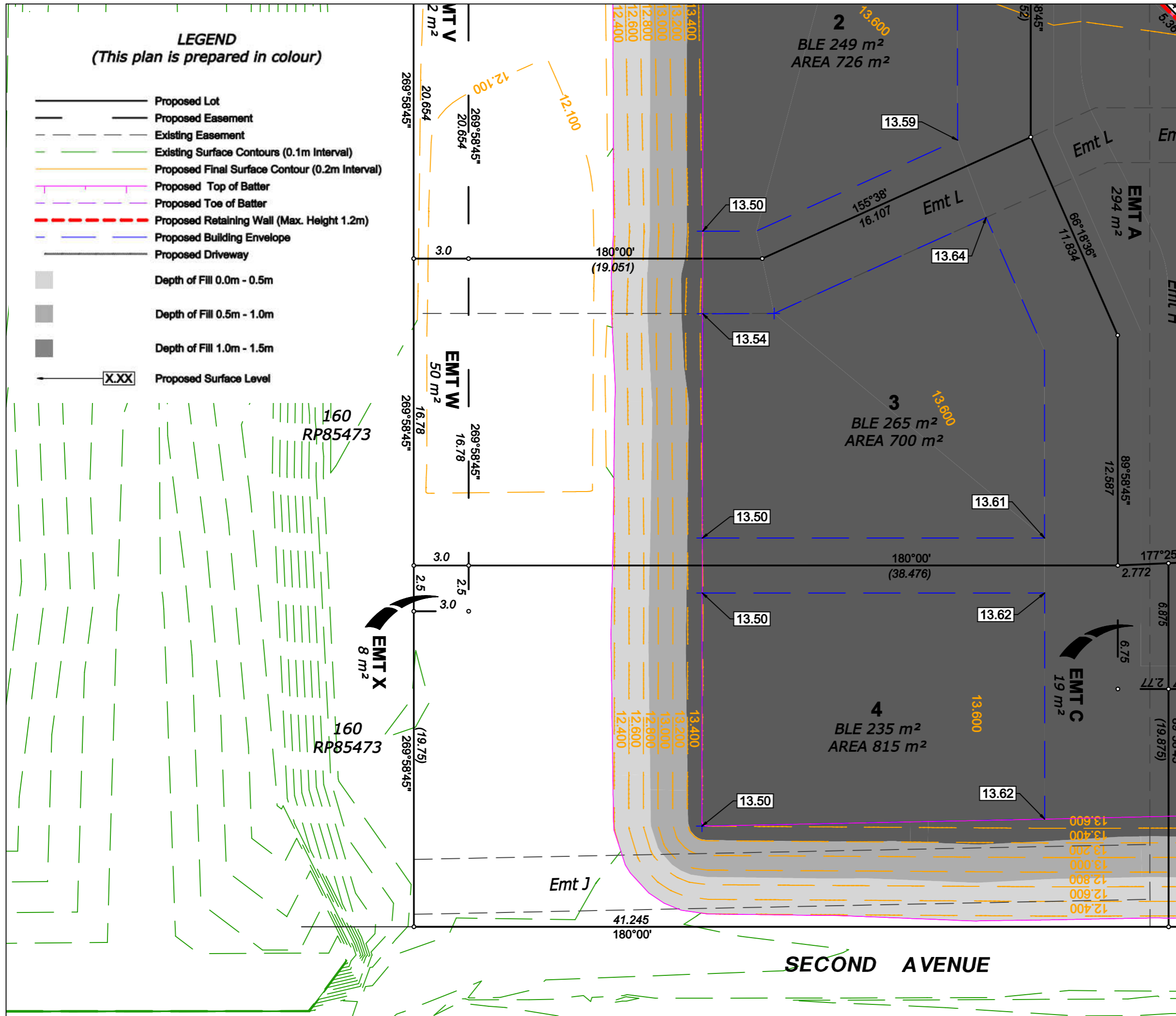

LEGEND
 (This plan is prepared in colour)

- Proposed Lot
- Proposed Easement
- Existing Easement
- Existing Surface Contours (0.1m Interval)
- Proposed Final Surface Contour (0.2m Interval)
- Proposed Top of Batter
- Proposed Toe of Batter
- Proposed Retaining Wall (Max. Height 1.2m)
- Proposed Building Envelope
- Proposed Driveway
- Depth of Fill 0.0m - 0.5m
- Depth of Fill 0.5m - 1.0m
- Depth of Fill 1.0m - 1.5m
- Proposed Surface Level

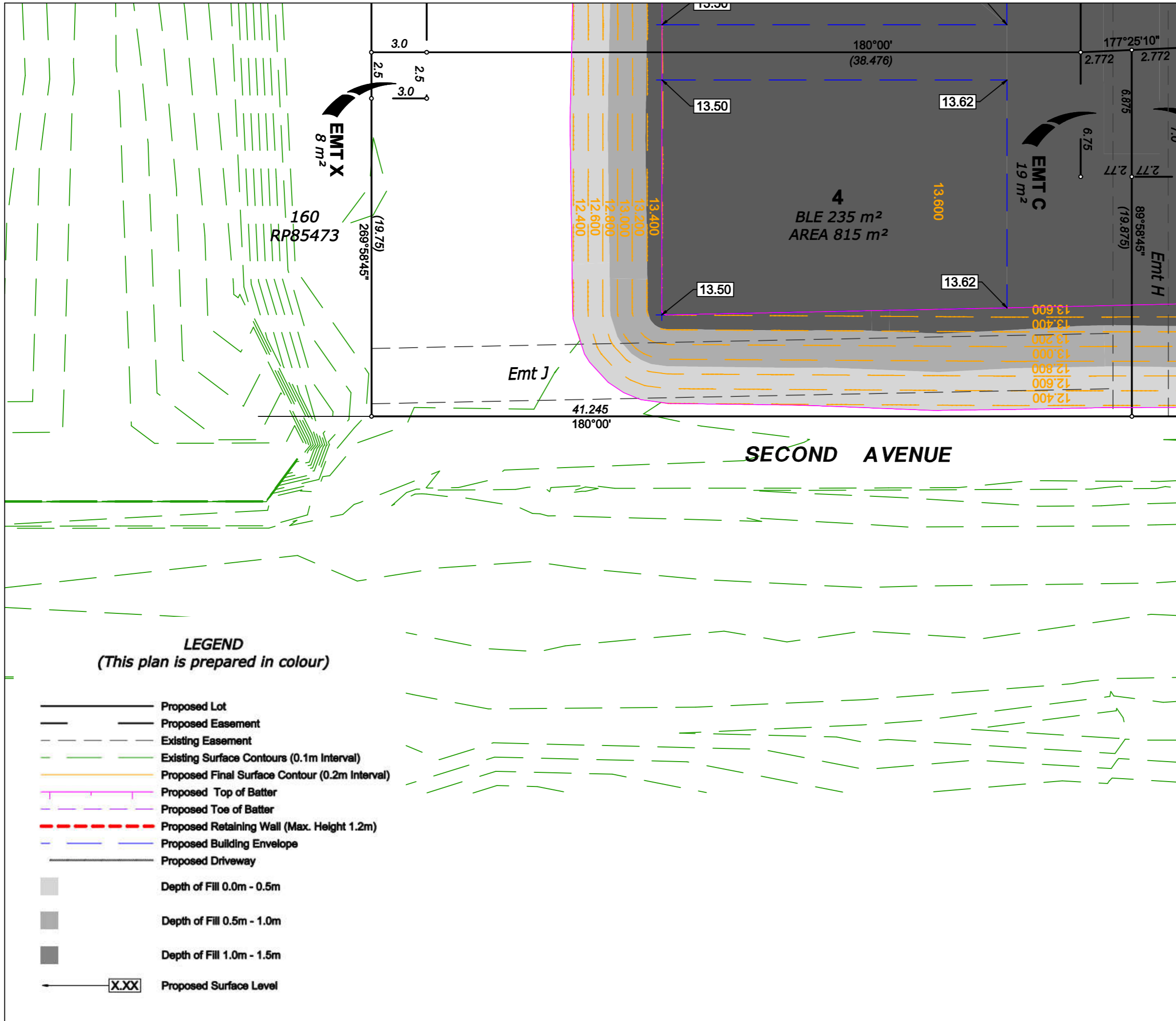

DISCLOSURE PLAN

FOR PROPOSED LOT
Currently Described as
Part of Lot 102 on SP303506 and
Part of Lot 14 on SP240909
Locality: Marsden
Local Government: Logan City

I, Kieran John McKeon of Kaymak Survey Pty Ltd
(ACN 150160615), certify that the details on this
sketch are correct.

Kieran John McKeon

This sketch has been prepared for
WIN Housing Projects Pty Ltd

for the purposes of disclosure under the Land Sales
Act. It is not to be used for any other purpose or by
any other person or corporation.

All areas and dimensions are subject to survey plan
registration and relevant authority approval.

Compaction of fill will be done in accordance with
Australian Standard AS3798-2007 to Level 1 inspection
and testing and the inspection of field density testing
will be in accordance with Table 8.1 of AS3798-2007.

Dimensions, levels and contours shown are not to be
used for building design or construction, a site survey
is required.

Existing surface levels and features are provided by
AJS surveys.

Proposed finished levels, contours and retaining walls
are provided by Michael Bale and Associates.

These notes form an integral part of this plan and no
part of this plan may be reproduced in whole or in part
without these notes. Plan prepared in colour.

KAYMAK SURVEY PTY LTD
ACN 150 160 615
ABN 46 257 320 173
1a 15a Leda Drive
Burleigh Heads
Queensland, 4220
PO Box 2606
Burleigh BC, Burleigh Waters
QLD 4220
www.kaymaksurvey.com.au
07 5576 0264

DRAWN	DATE	CHECKED	DATE
KM	10/2022	KM	10/2022

AMENDMENTS

Fill depths, easements, building envelopes

SCALE at A3 : 1:200

DRAWING No: 211107-DP-L4-01

SURVEYORS REF: 211107

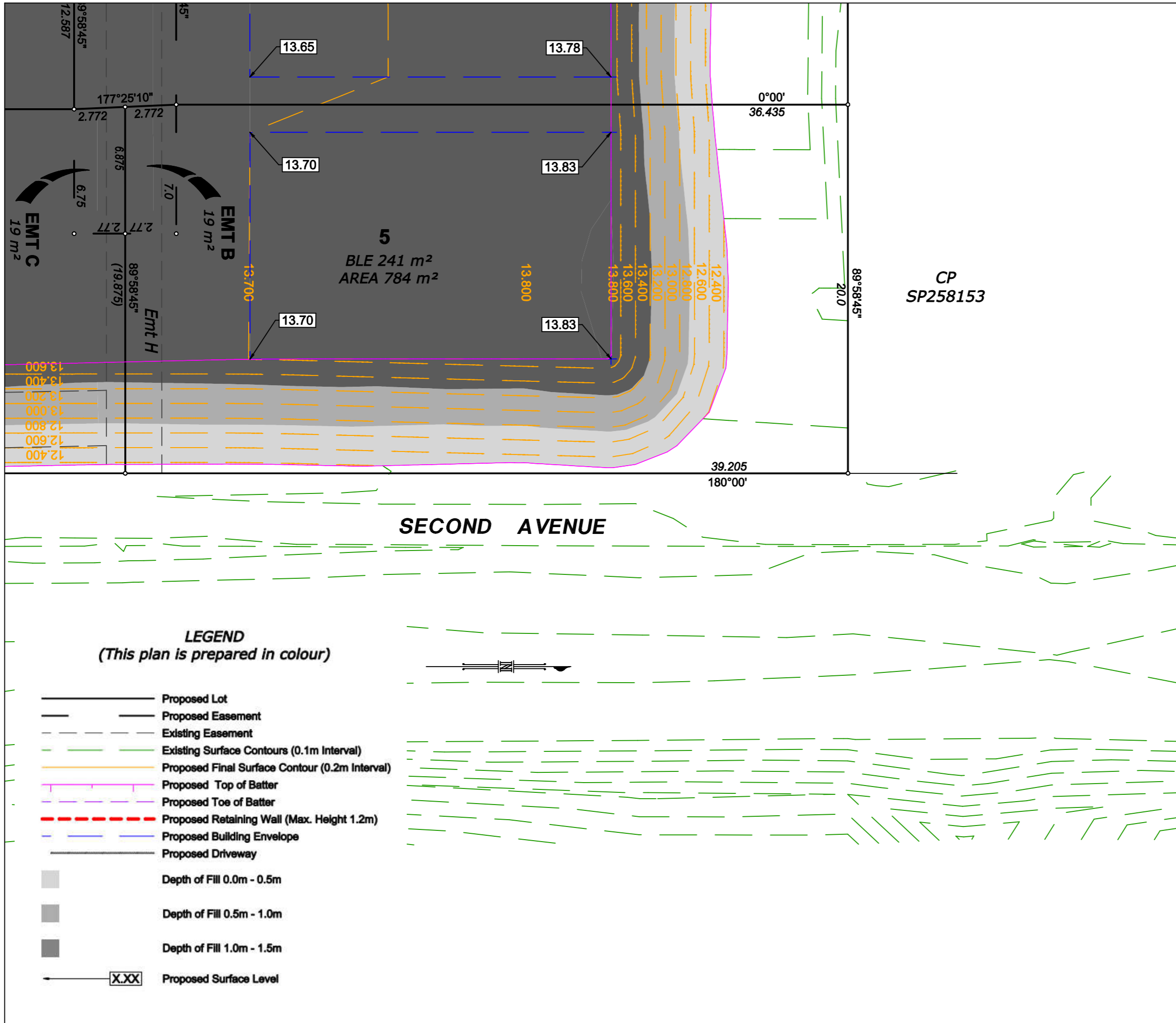

DISCLOSURE PLAN

FOR PROPOSED LOT
Currently Described as
Part of Lot 102 on SP303506 and
Part of Lot 14 on SP240909
Locality: Marsden
Local Government: Logan City

I, Kieran John McKeon of Kaymak Survey Pty Ltd
(ACN 150160615), certify that the details on this
sketch are correct.

Kieran McKeon

This sketch has been prepared for
WIN Housing Projects Pty Ltd

for the purposes of disclosure under the Land Sales
Act. It is not to be used for any other purpose or by
any other person or corporation.

All areas and dimensions are subject to survey plan
registration and relevant authority approval.

Compaction of fill will be done in accordance with
Australian Standard AS3798-2007 to Level 1 inspection
and testing and the inspection of field density testing
will be in accordance with Table 8.1 of AS3798-2007.

Dimensions, levels and contours shown are not to be
used for building design or construction, a site survey
is required.

Existing surface levels and features are provided by
AJS surveys.

Proposed finished levels, contours and retaining walls
are provided by Michael Bale and Associates.

These notes form an integral part of this plan and no
part of this plan may be reproduced in whole or in part
without these notes. Plan prepared in colour.

KAYMAK SURVEY PTY LTD
ACN 150 160 615
ABN 46 257 320 173
1a 15a Leda Drive
Burleigh Heads
Queensland, 4220
PO Box 2606
Burleigh BC, Burleigh Waters
QLD 4220
www.kaymaksurvey.com.au
07 5576 0264

DRAWN	DATE	CHECKED	DATE
KM	10/2022	KM	10/2022

AMENDMENTS

Fill depths, easements, building envelopes

SCALE at A3 : 1:200

DRAWING No: 211107-DP-L5-01

SURVEYORS REF: 211107

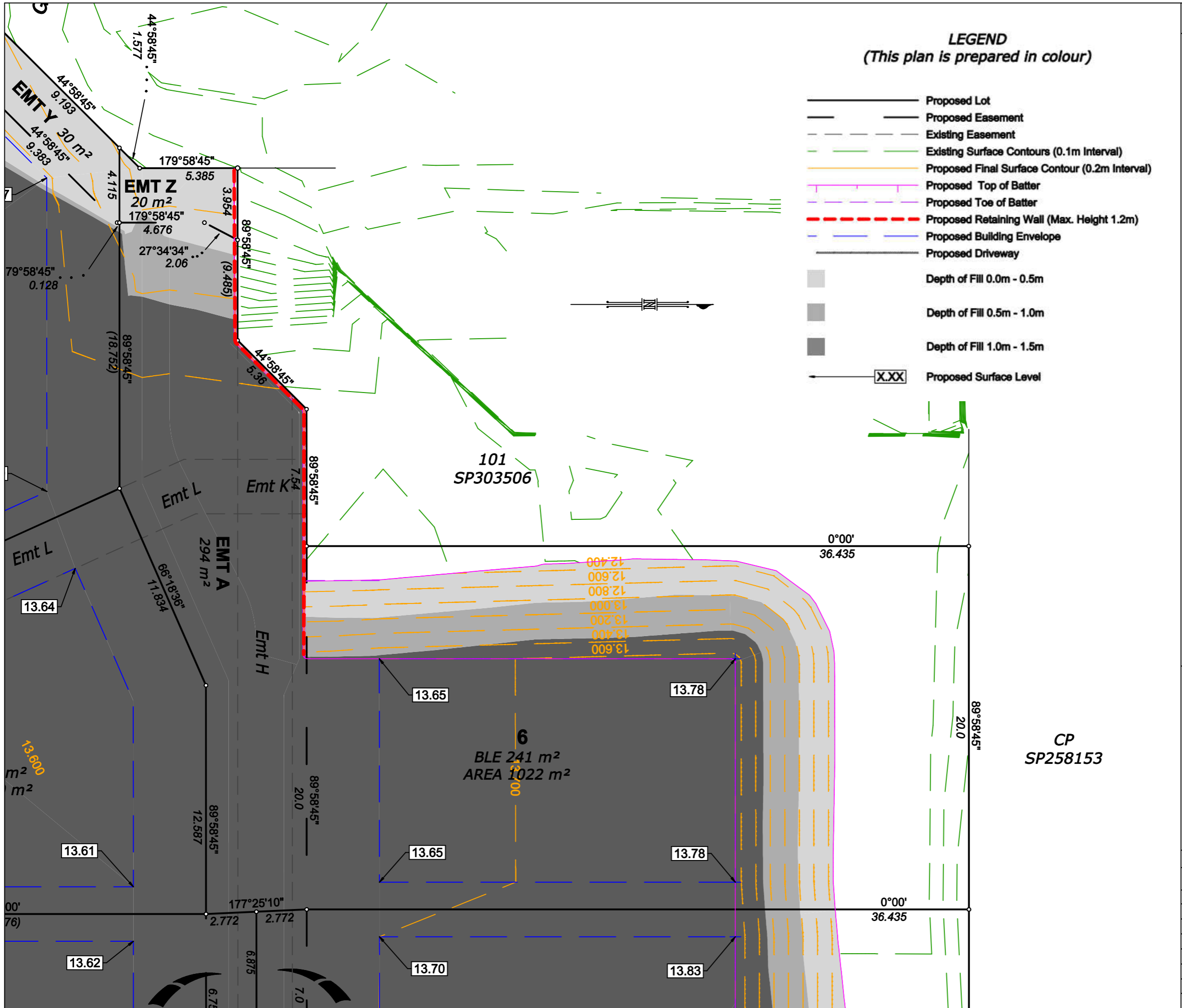

DISCLOSURE PLAN

FOR PROPOSED LOT
Currently Described as
Part of Lot 102 on SP303506 and
Part of Lot 14 on SP240909
Locality: Marsden
Local Government: Logan City

I, Kieran John McKeon of Kaymak Survey Pty Ltd
(ACN 150160615), certify that the details on this
sketch are correct.

Kieran John McKeon

This sketch has been prepared for
WIN Housing Projects Pty Ltd

for the purposes of disclosure under the Land Sales
Act. It is not to be used for any other purpose or by
any other person or corporation.

All areas and dimensions are subject to survey plan
registration and relevant authority approval.

Compaction of fill will be done in accordance with
Australian Standard AS3798-2007 to Level 1 inspection
and testing and the inspection of field density testing
will be in accordance with Table 8.1 of AS3798-2007.

Dimensions, levels and contours shown are not to be
used for building design or construction, a site survey
is required.

Existing surface levels and features are provided by
AJS surveys.

Proposed finished levels, contours and retaining walls
are provided by Michael Bale and Associates.

These notes form an integral part of this plan and no
part of this plan may be reproduced in whole or in part
without these notes. Plan prepared in colour.

KAYMAK SURVEY PTY LTD
ACN 150 160 615
ABN 46 257 320 173
1a 15a Leda Drive
Burleigh Heads
Queensland, 4220
PO Box 2606
Burleigh BC, Burleigh Waters
QLD 4220
www.kaymaksurvey.com.au
07 5576 0264

DRAWN	DATE	CHECKED	DATE
KM	10/2022	KM	10/2022

AMENDMENTS

Fill depths, easements, building envelopes

SCALE at A3 : 1:200
DRAWING No: 211107-DP-L6-01
SURVEYORS REF: 211107