

LION  **LAND MARKETING**



Murphy's Ridge

MURPHY'S CREEK / TOOWOOMBA / QLD.

Rural Lifestyle - City Convenience...

LION 
LAND MARKETING

1300 138 185



MURPHY'S RIDGE ESTATE
MURPHY'S CREEK



Building with freedom...

There is no Building Covenant required for Costello Junction which means you have freedom to build any design you wish.



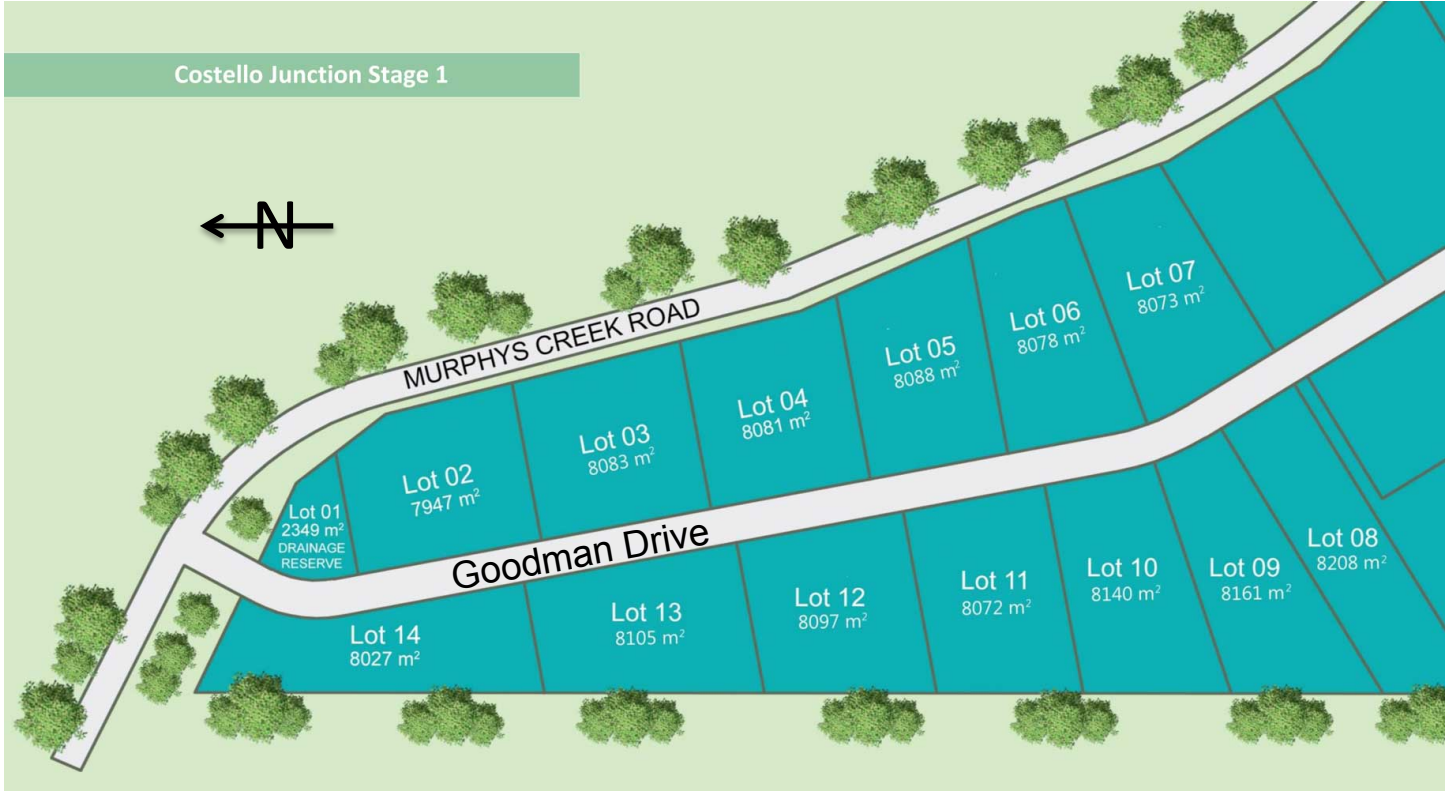

Murphy's Ridge Estate, 1043 Murphy's Creek Road. Murphy's Creek QLD.					
Lot No.	Street Name	Land m2	Frontage m.	Price	Status
3, Stage 1	Goodman Drive	8083m2	92m.	\$314,900.00	Available
4, Stage 1	Goodman Drive	8081m2	86m.	\$314,900.00	Available
5, Stage 1	Goodman Drive	8088m2	75m.	\$314,900.00	Available
6, Stage 1	Goodman Drive	8078m2	75m.	\$314,900.00	Available
8, Stage 1	Goodman Drive	8208m2	46m.	\$319,000.00	SOLD
13, Stage 1	Goodman Drive	8787m2	115m.	\$314,900.00	Available
14, Stage 1	Goodman Drive	8028m2	132m.	\$319,400.00	Available
Land and prices are subject to availability and can change without notice. Prices are correct as at 19/12/2023					
This Land is Registered and ready to build on.					
All blocks will have Full Pressure Town Water / and will require a Septic System.					



MURPHY'S RIDGE ESTATE
MURPHY'S CREEK



Welcome to **COSTELLO JUNCTION** Murphy's Creek

Rural Living At Its Finest

Perched in the heart of Murphy's Creek in the Darling Downs, Costello Junction offers an exciting new lifestyle opportunity with beautiful bushland on your doorstep and within driving distance to the bustling Toowoomba CBD and Airport.

You can own your own 2-acre private lot with full pressure town water from as little as \$315,000.

These 47 lots are one of a kind. Whether you are working in Toowoomba, downsizing, or expanding your family, or just looking for a change of scenery, Costello Junction is a new and exciting hidden gem.... in fact, some would say it's the perfect spot to build a dream home. We've made room for generous lot sizes that give you the space to make your dream home a reality, whether it be for either your residence or holiday home. Our 47 lots range from a generous 8,000m² to 19,000m² depending on your needs and budget. These beautiful country-style lots provide the perfect place to take a breath and relax, away from the stress of city living.

Murphy's Creek is a rural hamlet with local schools, convenience store and modern tavern.

Costello Junction Location

The city of Toowoomba and surrounding area boasts a resident population of over 185,000 and growing. With increasing growth and many opportunities for employment, the Toowoomba area is ideal for growing families.



Living at Murphy's Creek blends tranquil rural living with big city convenience. You can travel just 20 minutes up the road to the Toowoomba CBD or an hour and a half to the Gold Coast or Brisbane. Nearby is the beautiful Spring Bluff Railway Station that the locals love so much. Visitors can wander through the award-winning flower gardens while enjoying a relaxing cup of coffee or cake in the popular cafe.

Although it is hard to imagine, around 100 years ago Murphy's Creek was a thriving business centre but later transformed into the relaxing setting it now is as Toowoomba became one of Queensland's biggest and busiest cities.

STAGE 1

Stage 1 will be settling in October 2022 with Stage 2 commencing construction straight after with a completion date expected for mid-2023.

MURPHY'S RIDGE ESTATE
 MURPHY'S CREEK

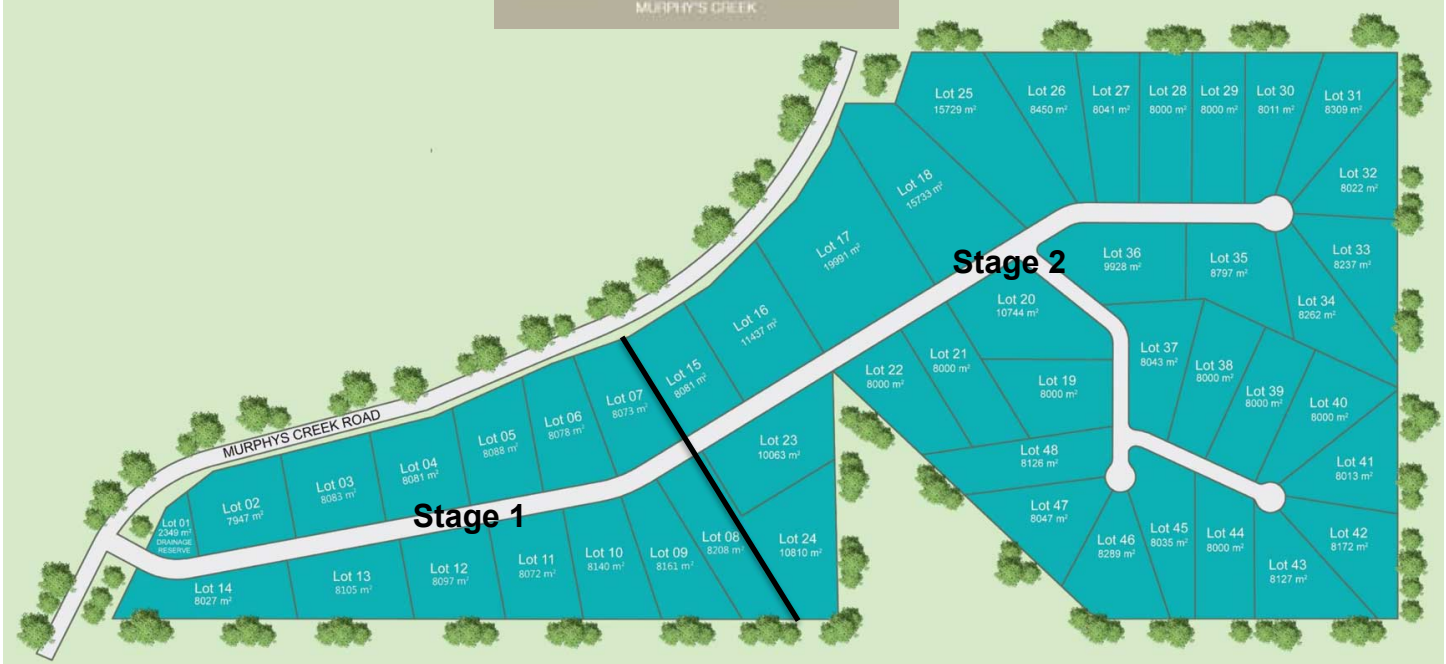

LION LAND MARKETING

LION
LAND MARKETING



Klaus Ferck

The Trusted Name In Property For Over 30 Years

Principal

LION LAND MARKETING

klaus@lionrealty.com.au

M: 0409 496 066 / Ph: 07 3279 7718

www.Lionlandmarketing.com.au



Mortgage Achievers Pty Ltd ABN 42 377 341 554 Australian Credit Licence No 415921

Intelligent Finance Solutions

Our professional services include:

- Tailored finance solutions
- Sourcing lowest cost mortgage finance
- Loan structure advice
- Construction loans

Please contact Renee Black

0413 957 781 - rblack@mortgageachievers.com.au

Tiresa Divitini Conveyancing Services

Tiresa Divitini

M: 0416 198 610

E: tdivitini@outlook.com



The fees for a purchase are \$880.00. I offer Lion Realty clients a discount of \$75.00, bringing it down to only \$805.00 plus disbursements and searches,

I service the whole of the Brisbane area. I am happy to help clients after hours and on week-ends.