

Maywood Street Loganlea QLD. off Rosella Street



Boutique Estate in an Established area of Loganlea

Currently we have 1 block available in this small Estate off Rosella Street Loganlea.

There is Body Corp in this Estate for the private road, it is about \$10.75 per week.

LION 
LAND MARKETING

1300 138 185

Maywood Street Loganlea QLD. off Rosella Street

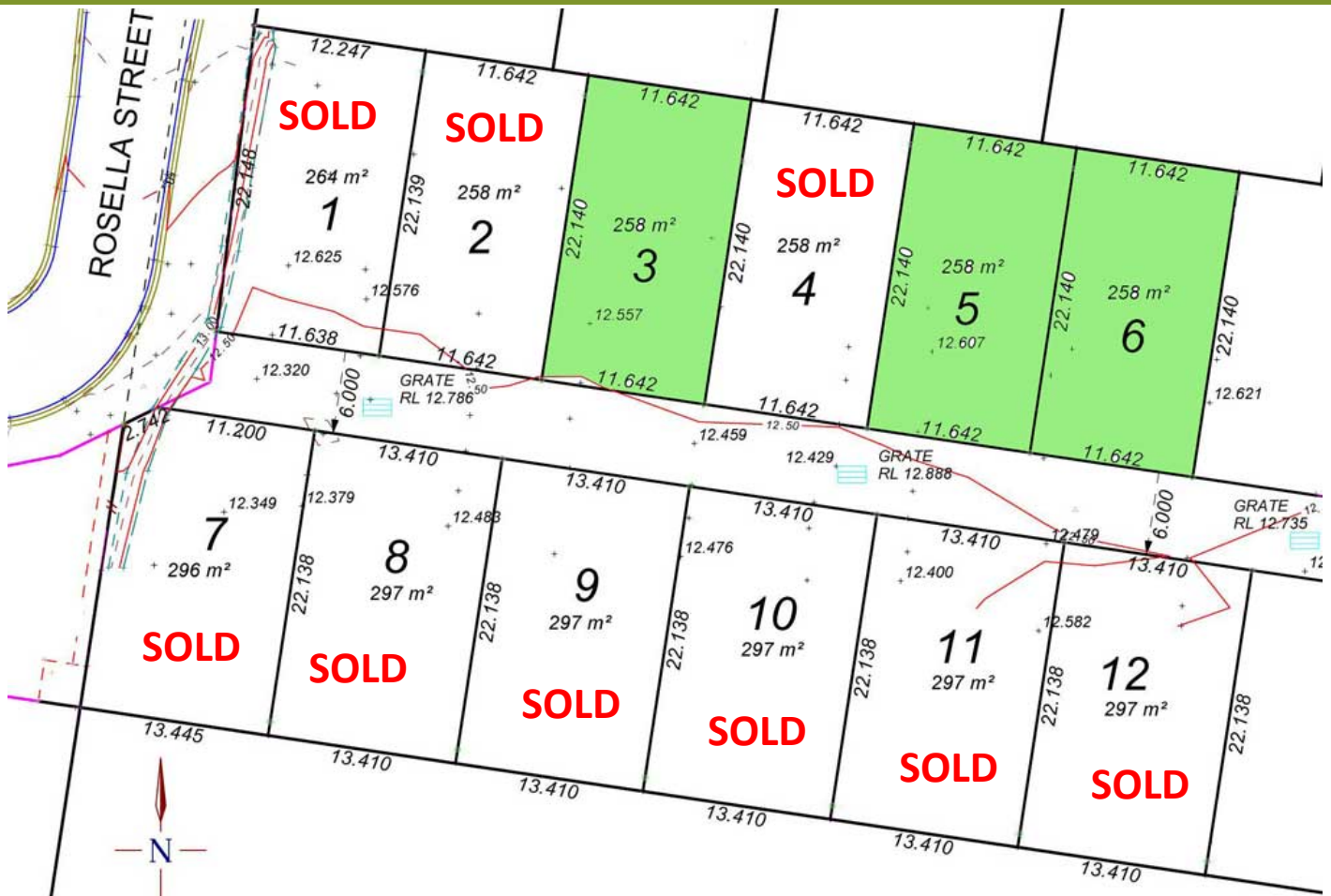

Lot 1	264m2		SOLD
Lot 2	258m2		SOLD
Lot 3	258m2	\$315,000	Available
Lot 4	258m2		SOLD
Lot 5	258m2	\$315,000	Available
Lot 6	258m2	\$315,000	Available
Lot 7	296m2		SOLD
Lot 8	297m2		SOLD
Lot 10	297m2		SOLD
Lot 11	297m2		SOLD
These blocks are Registered and ready to build on			
There is Body Corp in this Estate for the private road, it is about \$10.75 per week.			

LION
LAND MARKETING

1300 138 185

Maywood Street Loganlea QLD. off Rosella Street

Estate Location:

Maywood Street off Rosella Street Loganlea

Bus Stop: about 350m

Neighbourhood Shops: about 1.1km*

Loganlea Station: about 2.3km*

Logan Hospital: about 3km*

TAFE Qld. Loganlea Campus: about 3.4km*

Loganlea High School: about 3.1km*

Waterford West State School: about 1km*

Waterford Shopping Plaza: about 1.1km*

Meadowbrook Shopping Village: about 3.3km*

Griffith University Logan Campus: about 4.7km.*

Marsden Park Shopping centre: about 2.9km*

Club Hotel Waterford: about 1.1km*

Marsden High School: about 3.7km*

Kingston College: about 4.3km*

Groves Christian College: about 4.7km*

Hyperdome Shopping Centre: about 9km*

Brisbane CBD about: 30km*.

Brisbane Airport about: 38km*

Gold Coast: 60km*

Please note: (*Information supplied by Google Maps)



LION 
LAND MARKETING

1300 138 185