

**THE METES AND BOUNDS DESCRIPTION OF PROPOSED ALLOTMENT 39**

Commencing at the South West corner of Proposed Lot 38;  
 Thence, 280° 02' 05" for a distance of 5.746m,  
 Thence, 295° 00' 05" for a distance of 3.11m,  
 Thence, 324° 56' 05" for a distance of 3.11m,  
 Thence, 354° 52' 10" for a distance of 3.11m,  
 Thence, 9° 50' 10" for a distance of 23.266m,  
 Thence, 24° 53' 35" for a distance of 3.1m,  
 Thence, 54° 58' 20" for a distance of 3.1m,  
 Thence, 85° 03' for a distance of 3.1m,  
 Thence, 100° 04' 10" for a distance of 5.746m,  
 Thence, 189° 50' 10" for a distance of 35.255m,  
 to the point of commencement and containing an area of 396m<sup>2</sup> (more or less).

**Building Envelope Area: 247m<sup>2</sup>**

- Proposed Building Envelope. Offsets:
- Build to Boundary (East Only)
  - Build to Easements (South & West)
  - 3m from Front Boundary
  - 1m from Side Boundary

All earthworks shall be carried out in Accordance with AS3798-2007 with a testing regime in accordance with AS2007-1996 and further compaction methodology in Accordance with AS3798-1996.

Spot Levels interpolated, Contours and Retaining Wall Locations from As Constructed survey information provided by Limitless Projects on 6/03/2018

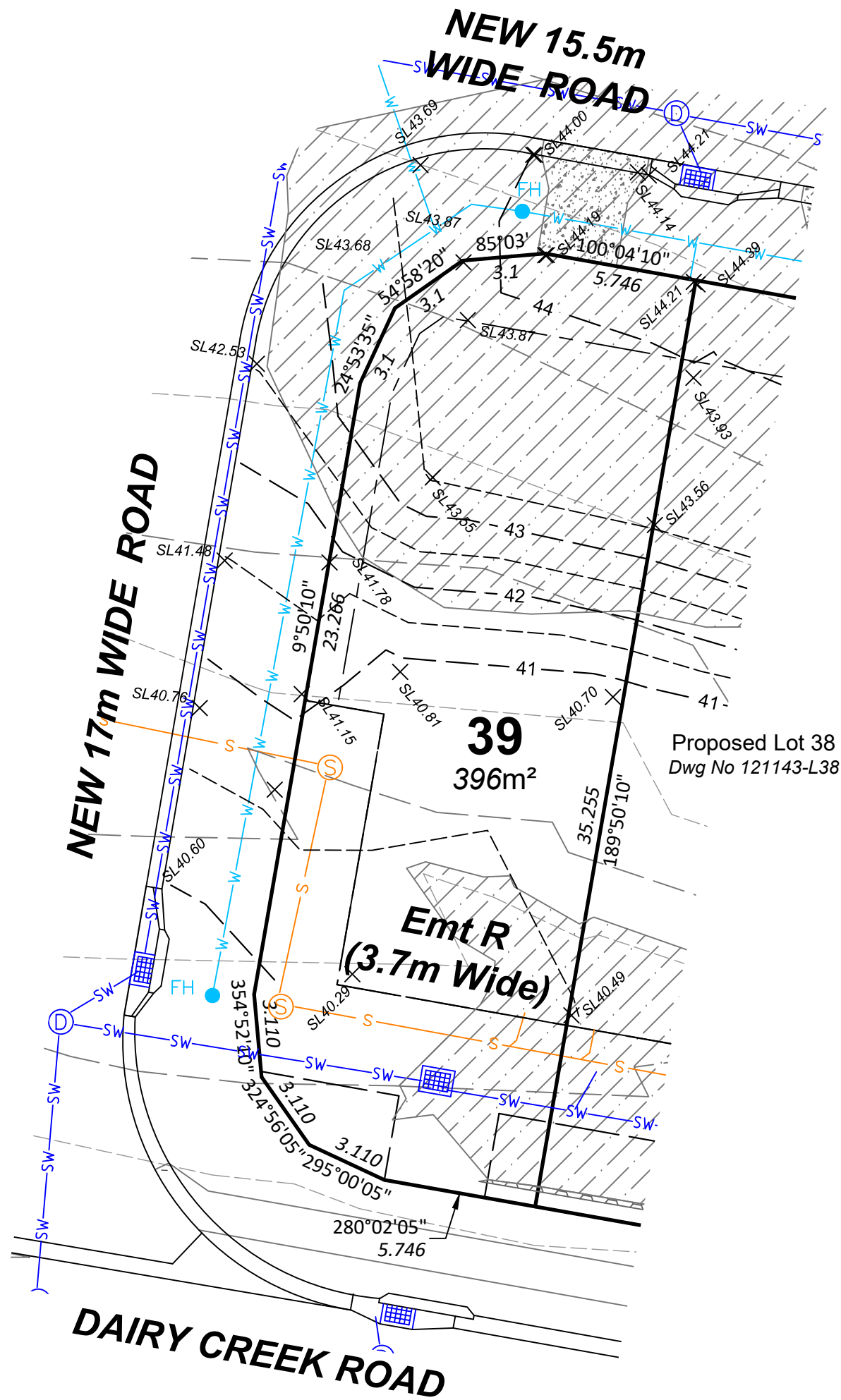

Telstra & U/G Electricity will be supplied to each lot

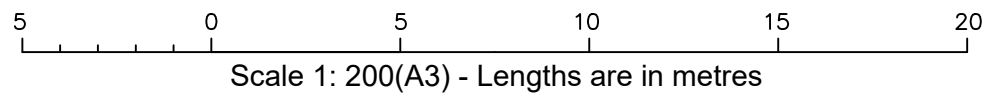

Toohey Survey Pty Ltd ABN 42 088 495 354  
 (07) 3800 4331 tooheysurvey.com.au

Client:  
**ACE Finance Pty Ltd**

This plan shows details of Proposed Allotment 39 on the Proposal Plan 13845-0-01/F which accompanied the application OW/424/2016 and was approved by Logan City Council on Date 31/05/2017

Notes:  
 Datum - AHDD  
 Level Origin - PM96424 (RL56.214)  
 Contour Interval - 0.5m.  
 Meridian - SP282331

EXISTING	
	Surveyed Major Contour
	Surveyed Minor Contour
	Fill
	Boulder Retaining Wall
	Concrete
	Proposed Sewer
	Proposed Stormwater
	Proposed Water
	Sewer Manhole
	Stormwater Manhole
	Field Inlet
	Fire Hydrant

**DISCLOSURE PLAN**

OF Proposed Allotment 39  
 298 - 302 Dairy Creek Road  
 WATERFORD

ORIG: Por.160  
 LOCALITY: WATERFORD  
 LOCAL GOVERNMENT: LOGAN CITY

Scale 1:200 Date 10/10/2018

Surveyor - Dwg No 121143-L39 Issue E