

RADIUS STREET

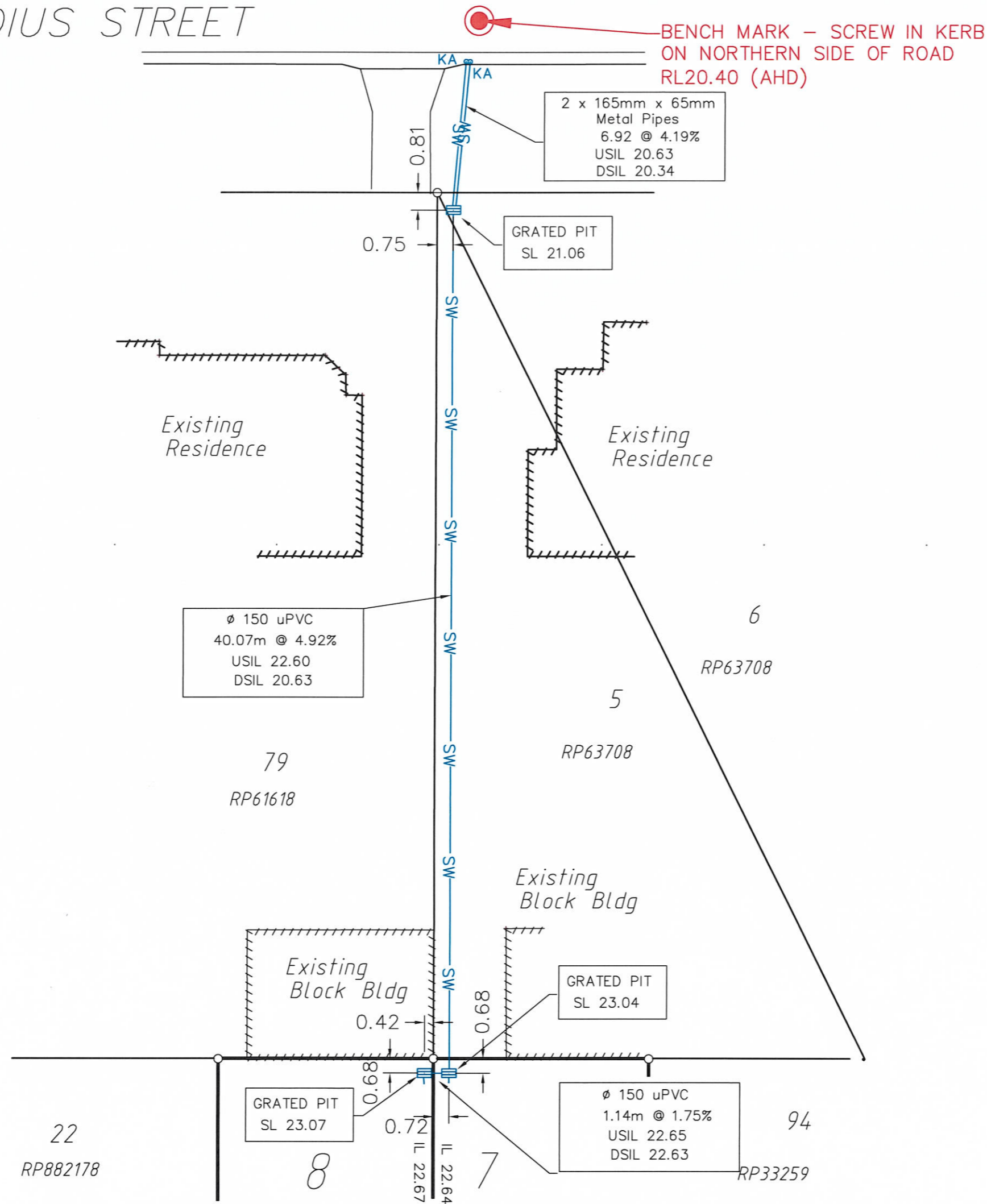

BENCH MARK - SCREW IN KERB ON NORTHERN SIDE OF ROAD RL20.40 (AHD)

2 x 165mm x 65mm Metal Pipes
6.92 @ 4.19%
USIL 20.63
DSIL 20.34

GRATED PIT
SL 21.06



∅ 150 uPVC
40.07m @ 4.92%
USIL 22.60
DSIL 20.63

GRATED PIT
SL 23.04

GRATED PIT
SL 23.07

∅ 150 uPVC
1.14m @ 1.75%
USIL 22.65
DSIL 22.63

LEGEND TO SYMBOLS

-  BENCH MARK
-  GRATED PIT
-  SW STORMWATER

It is certified that the locations, levels and dimensions of the infrastructure shown herein are a true representation of the constructed works and that the As-Constructed survey was performed to the prescribed accuracy standards.

Registered/Licensed Surveyors signature: 

Company Title: Ken McDonald Surveys

REVISION	DATE	ZONE
0 For Information	25/11/16	

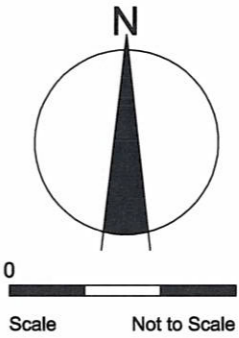

Ken McDonald SURVEYS
14 Virginia Street, Virginia, Qld 4034
PO Box 307, Zillmere, Qld 4034
Tel: 07 3865 3658
Fax: 07 3865 7035

Surveyor	DL	25/11/16
Drawn	DL	25/11/16
Checked	AM	25/11/16
Approved	KM	25/11/16

59 Joffre St, Wynnum
As Constructed sketch of Stormwater on Proposed Lots 7 & 8, and Lot 5 & 6 on RP63708